

STYLUS COLOR 500

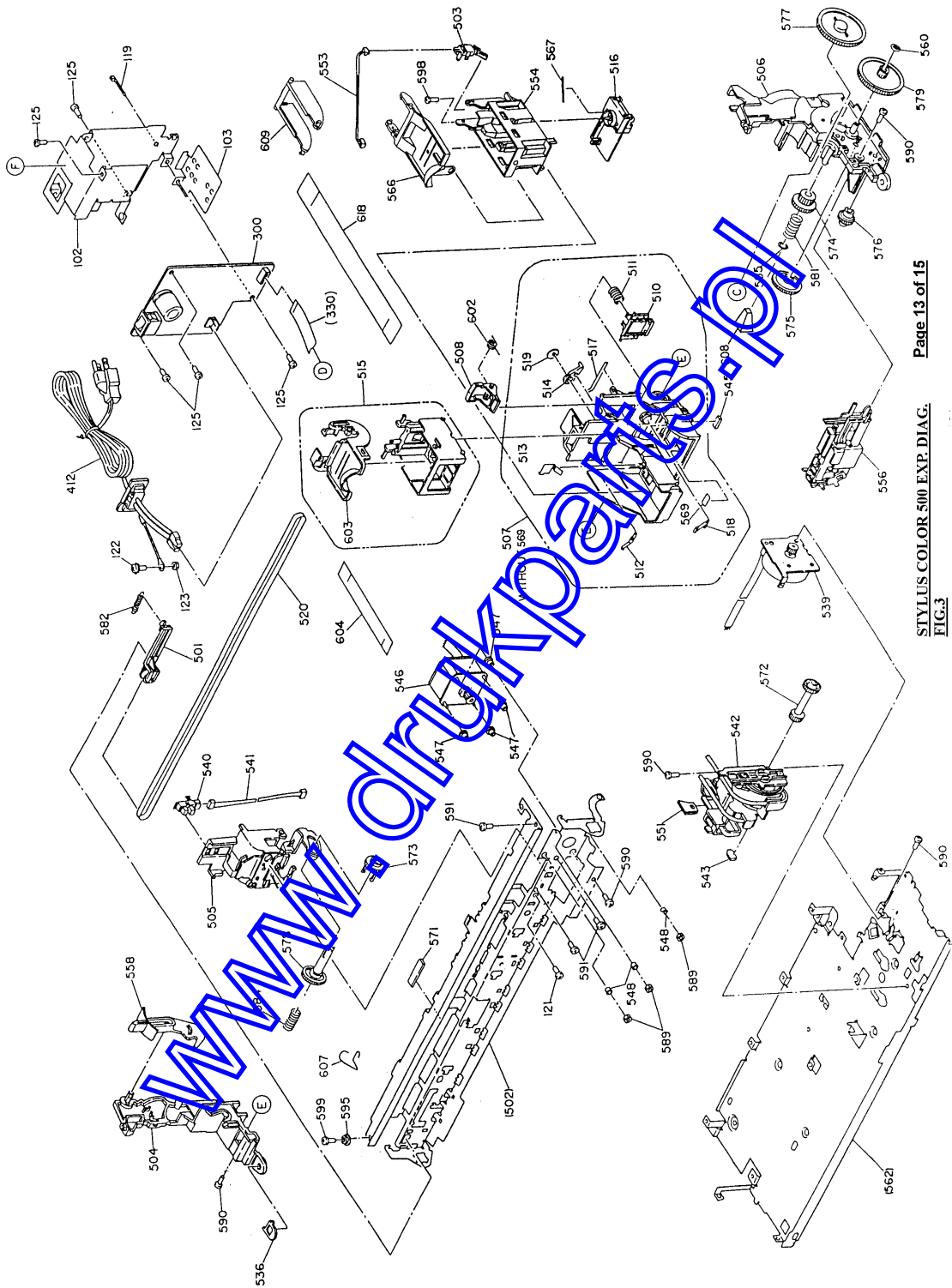

Page 13 of 15

STYLUS COLOR 500 EXP. DIAG.
FIG. 3

STYLUS COLOR 500

Page 11

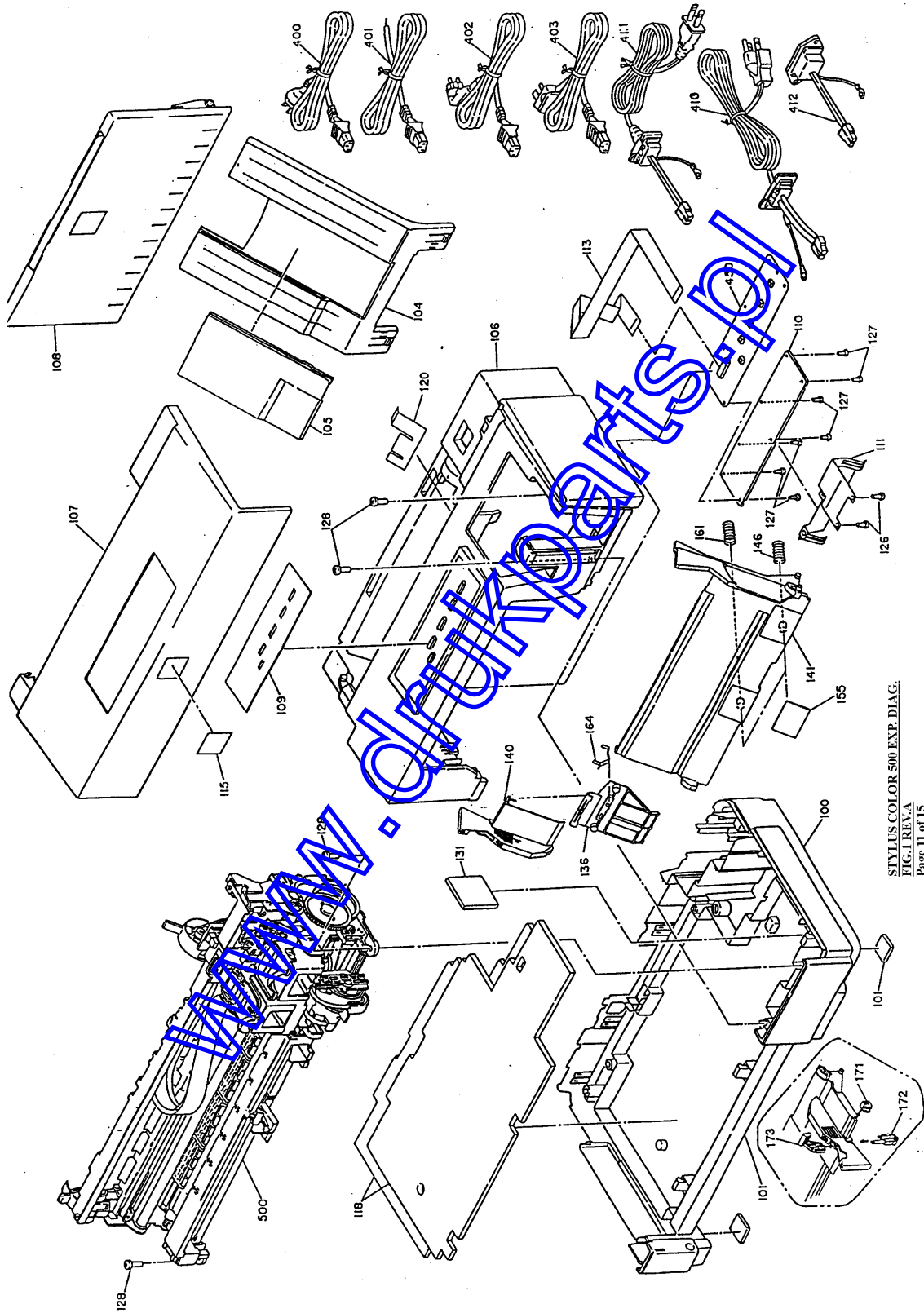

STYLUS COLOR 500 EXP. DIAG.
FIG.1 REV.A
Page 11 of 15

STYLUS COLOR 500

Page 10

REF.	Part No.	Description	Standard	Qty	Remarks

www.drukparts.pl

STYLUS COLOR 500

Page 3

REF.	Part No.	Description	Standard	Qty	Remarks
513	1023318	GROUNDING PLATE, HEAD		1	
514	1023323	LEVER, CHANGE		1	
515	F049001	PRINT HEAD, IJ60-0AC	COLOUR	1	KIT NO. F049001-C
516	F046030	PRINT HEAD, IJ64-0BC	BLACK	1	KIT NO F046030-C
517	1023324	ROD SPRING,		1	
518	1023750	LEVER, ADJUST, C		1	
519	1024139	BUSHING, LEVER, CHANGE		1	
520	1023301	TIMING BELT		1	
521	2017339	CABLE, HEAD, C	COLOUR	1	
522	2017342	CABLE, HEAD, H	BLACK	1	
523	1023302	PR. GUIDE, UPPER		4	
524	1024645	PR. GUIDE, UPPER, LEFT		1	
525	1024887	PR. GUIDE, SUPPORT, UPPER		16	
526	1023298	PR. GUIDE, LOWER		1	
527	1023894	SHAFT, HOLDER, STAR WHEEL		1	
528	1023296	ROLLER, PR. EJECT		1	
529	1024041	STAR WHEEL ASSY.		7	
530	1024124	COIL SPRING, STAR WHEEL		7	
531	1024125	SPUR GEAR, 19.2		1	
532	1024126	SPUR GEAR, 10.8		1	
536	1024617	P/ PLATE, PR. GUIDE, LOWER		1	
537	1024107	ROLLER ASSY., PF, DRIVE		1	
538	2017340	HARNESS, PE DETECTOR		1	
539	2017344	MOTOR ASSY., PF	3.25W	1	
540	2021854	DETECTOR, HP	4V, 50MA, 100MW,	1	
541	2017341	HARNESS, HP		1	
542	1024087	PUMP ASSY.		1	
543	1024859	PRESSURE PLATE, PUMP		1	
544	1023214	SHAFT, CR, GUIDE		1	
545	1023322	OIL PAD		1	
546	2017343	MOTOR ASSY., CR	1.9W	1	
547	1024351	INSULATOR, MOTOR		4	
548	1024352	SPACER, INSULATOR		3	
549	1023999	ROLLER, DRIVEN		4	
551	1028109	CLEANER, HEAD, ASP;B		1	
552	1023218	HOLDER, HEAD, CABLE		1	
553	2017346	HARNESS, CARTRIDGE, DETECTOR		1	
554	1029239	HOLDER, CARTRIDGE, H;B		1	
555	1024854	HOLDER, CABLE		1	
556	1029054	CAP. ST.		1	
557	1023215	BUSHING, PARALLELISM ADJUST		2	
558	1023216	LEVER, PG		1	
559	1023217	LEVER, TRANSMISSION, PG		1	
560	1023219	BUSHING NAT, 2		1	
561	1023221	TUBULAR FITTINGS, GROUNDING		1	
562	1023232	SHIELD PLATE, M/B		1	
563	1023245	HEATSINK, TR		1	
565	1029044	MOUNTING PLATE, PE, DETECTOR		1	
566	1029240	LEVER, FASTEN, CARTRIDGE;B		1	
567	1023321	PIN, FASTEN, HEAD		1	
568	1024253	SPACER, 3X3		1	
569	1024354	SPACER, HEAD, C		1	
570	1024619	SHEET, BUSHING, PARALLEL ADJ.		2	
571	1024620	PAD, GROUNDING, PANEL		1	
572	1023227	COMBINATION GEAR, 12, 15		1	
573	1023250	SPUR GEAR, 14.4		1	

ESP0501/3

STYLUS COLOR 500

Page 2

REF.	Part No.	Description	Standard	Qty	Remarks
158	1024861	ROLLER, PR. GUIDE, ASF		2	
159	1024866	BUSHING, ASF		1	
160	1025389	EXTENSION SPRING, 0.461		2	
161	1025390	COMPRESSION SPRING, 1.079		1	
162	1025666	PLAIN WASHER, 8X9.5X0.3, S/NA		1	
163	1025667	COMPRESSION SPRING, 8.907		1	
164	1025897	PRESSURE PLATE, EDGE GUIDE;B		1	
165	2014283	DETECTOR, LEAF, B1	0, 0V, 0A,	1	
166	B310206611	C.B.B. SCREW	M4X16	1	
167	1001680	PLAIN WASHER	4X0.5X15	1	
168	1026157	CLAMP, CR		1	
169	1026158	METAL FITTINGS, CR		1	
170	B310206511	C.B.B. SCREW	M4X14	2	
171	1029485	BUSHING, LEVER, EDGE GUIDE		1	
172	1029486	LEVER, EDGE GUIDE, SUPPORT		1	
173	1029250	LEVER, EDGE GUIDE		1	
180	1029938	LABEL, CAUTION 1	EUROPE	1	
180	1029940	LABEL, CAUTION 1;C	USA, S.E.ASIA,	1	INC.OCEANIA
181	1029941	LABEL, CAUTION 2	EUROPE	1	
181	1029943	LABEL, CAUTION 2;C	USA, S.E.ASIA,	1	OCEANIA
182	1025805	LABEL, CAUTION 3	ALL COMPANIES	1	
184	1029944	LABEL, PR. CHANGE	EUROPE	1	
184	1029946	LABEL, PR. CHANGE;C	USA, S.E. ASIA,	1	OCEANIA
185	1029947	LABEL, PR. SET	EUROPE	1	
185	1029949	LABEL, PR. SET;C	USA, S.E.ASIA,	1	OCEANIA
186	1026217	LABEL, FASTEN, CR	EUROPE	1	
186	1029950	LABEL, FASTEN, CR	USA, S.E.ASIA,	1	OCEANIA
187	1029955	LABEL, ACCESSORY	USA,	1	FOR USA
200	2021739	BOARD ASSY., MAIN	FOR USA, S.E.ASIA,	1	WITHOUT IC3
200	2021741	BOARD ASSY., MAIN	FOR MLSP	1	WITHOUT IC3
200	2022226	BOARD ASSY., MAIN	FOR EUROPE	1	WITHOUT IC3
300	2018212	BOARD ASSY., POWER SUPPLY	20V	1	
300	2018213	BOARD ASSY., POWER SUPPLY	220V/240V	1	
330	2018027	HARNES		1	
400	2002364	POWER CABLE (VD3103SA-10A)	230V	1	
401	2006741	POWER CABLE (BS31303SA-SR-10A)	240V	1	
402	2010468	AC CABLE	240V	1	
403	2002365	POWER CABLE (VD6833SA-10A)	220V	1	
403	2008768	POWER CABLE	220V	1	FOR EHK
410	2018026	POWER CABLE ASSY.		1	
411	2018025	POWER CABLE ASSY.		1	
412	2018028	HARNES		1	
450	2022155	BOARD ASSY., PANEL		1	
500	2022388	PRINTING MECHANISM	M-4D11	1	WITHOUT *8)MARK
501	1024103	ROLLER ASSY., DRIVEN		1	
502	1023210	FRAME, BASE		1	
503	2017754	DETECTOR, PE	0V, 0A, 0W,	2	
504	1023211	FRAME, LEFT		1	
505	1024086	FRAME ASSY., MIDDLE		1	
506	1024102	FRAME ASSY., RIGHT		1	
507	1024100	CARRIAGE ASSY.		1	
508	1023281	LEVER, HEAD, FASTEN		1	
509	1023292	HOLDER, STAR WHEEL		1	
510	1023285	HOLDER, SPRING		1	
511	1023286	COMPRESSION SPRING, 7.79		1	
512	1023315	LEVER, ADJUST, H		1	

STYLUS COLOR 500

(INCLUDES DETAILS OF NEWLY-AVAILABLE PRINT-HEAD KITS)

Page 1

REF.	Part No.	Description	Standard	Qty	Remarks
100	1023222	HOUSING, LOWER		1	
101	1004605	FOOT		2	
102	1023234	SHIELD PLATE, P/S, MAIN		1	
103	1024182	SHIELD PLATE, P/S, SUB		1	
104	1023226	PR. GUIDE, MAIN		1	
105	1023238	PR. GUIDE, CENTRE		1	
106	1024146	HOUSING ASSY. UPPER		1	
107	1023223	COVER, PRINTER		1	
108	1024143	STACKER ASSY., PR. EJECT		1	
109	1029951	SHEET, PANEL		1	
110	1025832	FASTENING PLATE, PANEL, BOARD		1	
111	1023242	GROUNDING PLATE, PANEL		1	
113	2018040	CABLE, PANEL		1	
114	2018707	HARNES, ASF		1	
115	1029953	LOGO PLATE		1	
116	1024138	SHEET, HEAT CONDUCTOR		1	
117	1024233	FASTENING PLATE, TR		1	
118	1029057	POROUS PAD, INK EJECT		2	
119	X522000010	WIRE BAND		1	
120	1029253	SHEET, SEPARATOR CROW		1	
121	B010303411	C.B.SCREW	M3X8	1	
122	B045800115	C.B.(O) SCREW	M4X8	1	
123	B070200411	HEXAGON NUT	M4	1	
125	B300204311	C.B.S. SCREW	M3X8	12	
126	1005019	C.B.P-TITE SCREW, 3X8, F/ZN	M3X8 F/ZN	2	
127	1012350	C.B.P-TITE, 3X10, F/ZN		10	S/B P4245
128	1024145	C.B.P.SCREW, 4X12, F/ZN		2	
129	1002674	C.B.S-TITE SCREW	M3X12	1	
130	1025569	C.B.P-TITE(S-P2), 3X12, F/ZN		7	S/B P4245
131	1026156	POROUS PAD, SUPPORT		1	
132	1025871	ROLLER ASSY., PR. LOAD		1	
133	1023251	LEVER, RELEASE, S'TOR CROW		1	
134	1023252	COMPRESSION SPRING, 1.96		1	
135	1023254	LEVER, SEPARATOR CROW		1	
136	1030235	HOLDER, SHAFT TRANSMISSION;C		1	
137	1023261	EXTENSION SPRING, 9.8		1	
138	1023264	S'TOR CROW		1	
139	1023266	FRAME, PR. LOAD		1	
140	1029237	EDGE GUIDE;B		1	
141	1029484	HOPPER		1	
142	1023282	SPUR GEAR, 27.2		1	
143	1023284	COMBINATION GEAR, 27.2, 36		1	
144	1024116	CLUTCH		1	
145	1024117	COMPRESSION SPRING 590		1	
146	1024118	COMPRESSION SPRING, 1.078		1	
147	1024125	SPUR GEAR, 19.2		1	
148	1024130	C.B.P-TITE SCREW, 3X6, F/ZN		1	
149	1024145	C.B.P.SCREW, 4X12, F/ZN		1	
150	1024438	FASTENING PLATE, ASF		1	
151	1024621	PAD, LEVER, RELEASE		1	
152	1024622	FASTENING PLATE, COMB. GEAR		1	
153	1024855	TORSION, ROD		1	
154	1024856	HOLDER, TORSION, ROD		2	
155	1024857	CORK, PR. LOAD		2	
156	1024858	MOUNTING PLATE, ASF, DETECTOR		2	
157	1024860	PR. GUIDE, ASF		2	