

EPSON STYLUS COLOR 300

REF	PART NO	STANDARD	QTY	DESCRIPTION
100	1022993		1	HOUSING, LOWER
101	1004605		4	FOOT
102	1024036		1	SHIELD PLATE, P/S
103	1024201		1	SHIELD PLATE, M/B, UPPER
104	1024202		1	SHIELD PLATE, REAR
105	1024203		1	SHIELD PLATE, I/F, LOWER
106	1024511		1	SHIELD PLATE, I/F
107	1035801		1	HOUSING, UPPER
112	1024038		1	SHEET, P/S
113	1024205		1	SHEET, M/B
115	1036165		1	LOGO PLATE
116	1035802		1	COVER, PRINTER
117	1022997		1	PAPER, SUPPORT
118	1035804		1	OPTICAL TUBE
119	2020393	1,0V,0A,	1	DETECTOR, LEAF, B2
120	2018724		1	HARNESS, DETECTOR, ASF
122	1024886		1	HOLDER, DETECTOR, ASF
123	1025611		1	POROUS PAD, INK EJECT
124	1025620		1	SHEET PROTECTION, CR MOTOR
126	B300204211	M3X6	15	C.B.S. SCREW
127	B300204311	M3X8	3	C.B.S. SCREW
128	1012350		2	C.B.P. TITE, 3X10, F/ZN
129	1020825		1	C.B.P. TITE, 2X8, F/ZN
130	1024145		1	C.B.F. SCREW, 4X12, F/ZN
131	1025826		1	C.B.F.S-TITE, 3X6, F/ZN
132	B045800115	M4X8 F/ZG	1	C.B.(O) SCREW
133	B070200411	M4	1	HEXAGON NUT
137	1029518		1	HOPPER;B
138	1029520		1	LEVER, EDGE GUIDE, SUPPORT
139	1029517		1	EDGE GUIDE;B
140	1030581		1	PRESSING PLATE, COLOUR CART.
142	1035803		1	BUTTON
143	1036461		1	HOLDER, M/B
153	1029521		1	FRAME, ASF;B
154	1031219		1	SEPARATOR CLAW;B
155	1024491		1	LEVER, SEPARATOR CLAW
156	1024736		1	EXTENSION SPRING, 0.755
158	1024191		2	CORK
161	1029522		1	LINK HOPPER
162	1029523		1	SHEET, ROLLER, PAPERLOAD
163	1030231		1	HOLDER, PAPER SUPPORT
164	1030232		1	SHEET, PAPER SUPPORT
165	1029519		1	LEVER, EDGE GUIDE
167	1029524		1	BUSHING, LEVER, EDGE GUIDE
200	2024800		1	BOARD ASSY., MAIN
CN1	2005881	21 PIN	1	CONNECTOR
CN3	X600440410	4 PIN	1	CONNECTOR
CN4	2018248	19,	1	CONNECTOR
CN5	2017929	4,	1	CONNECTOR
CN6	2017149	5,	1	CONNECTOR
CN7	X600440120	2 PIN	1	CONNECTOR
CN8	X600440310	3 PIN	1	CONNECTOR
CN9	2003678	2,	1	CONNECTOR
CR2	2021879	25MHZ,	1	CERAMIC OSCILLATOR
C1-C5	2002486	0.1UF DC25V +80% -20%	5	CHIP CAPACITOR
C10	X271122221	2200PF DC50V 10%	1	CHIP CAPACITOR
C11	2021880	TP,4700PF,50V,	1	CHIP CAPACITOR
C12	2014921	TP,220UF,50V,+,-20%,	1	AL'UUM. E'LYTIC. CAP.
C14-C18	2002486	0.1UF DC25V +80% -20%	5	CHIP CAPACITOR
C20-C22	2002486	0.1UF DC25V +80% -20%	3	CHIP CAPACITOR
C23-C60	X271124711	470PF 50V 10%	2	CHIP CAPACITOR

EPSON STYLUS COLOR 300

Page 2 of 8

REF	PART NO	STANDARD	QTY	DESCRIPTION
C28-C29	2002486	0.1UF DC25V +80% -20%	2	CHIP CAPACITOR
C30-C34	X271121021	1000PF DC50V 10%	2	CHIP CERAMIC CAPACITOR
C31-C33	2002486	0.1UF DC25V +80% -20%	2	CHIP CAPACITOR
C35	2017933	TP,220UF,10V,+20%,	1	AL'UUM. E'LYTIC. CAP.
C36-C37	2018119	BL,100UF,50V,+20%,	2	AL'UUM. E'LYTIC. CAP.
C38-C53	X281323301	33PF 50V 5%	2	CHIP CAPACITOR
C39-C40	2002486	0.1UF DC25V +80% -20%	2	CHIP CAPACITOR
C41-C43	X271124711	470PF 50V 10%	1	CHIP CAPACITOR
C44-C45	2002500	TP,4700PF,50V,+1	2	CHIP CAPACITOR
C46-C50	X281323301	33PF 50V 5%	5	CHIP CAPACITOR
C52-C54	2002486	0.1UF DC25V +80% -20%	2	CHIP CAPACITOR
C55-C58	2002486	0.1UF DC25V +80% -20%	2	CHIP CAPACITOR
C59-C64	X281323301	33PF 50V 5%	2	CHIP CAPACITOR
C6-C7	X271124711	470PF 50V 10%	2	CHIP CAPACITOR
C61-C66	X271124711	470PF 50V 10%	2	CHIP CAPACITOR
C65	2002486	0.1UF DC25V +80% -20%	2	CHIP CAPACITOR
C67	X271124711	470PF 50V 10%	1	CHIP CAPACITOR
C8-C9	2003503	TP,3300PF,50V,+10%,	2	CHIP CAPACITOR
D1-D11	2014230	80V,100MA,0MW,	2	DIODE
D2-D9	2004113	-50V 500MA	8	SHOT KEY
IC1	2024506		1	GATE ARRAY
IC10	2014681	SOP,1K BIT,8	1	EEPROM, AT93C46-18SC
IC11	X422350079	HEX BUF/DRV OC HI-VOCT	1	TTL-IC
IC15	X440004314	SHUNT REG. UPAK TP	1	VOLTAGE REGUL. ATOMIC
IC16	2018007		1	HIC
IC2	2021874	100 PIN	1	MICROCOMPUTER
IC3	X630114230	42 PIN	1	IC SOCKET
IC4	2015936		1	IC SOCKET
IC8	2017973		1	HIC CD-8291/EB-TR
IC9	2023625		1	RESET IC
LED1-LED2	2021878	0V,0MA,0MW,	2	CHIP LED
LED3	2021877	0V,0MA,0MW,	1	CHIP LED
QM1-QM6	2017228	40V,100MA,0W,120,0,	2	TRANSISTOR
QM3	2017885	50V,100MA,0W,0,0,	1	TRANSISTOR
QM4	2017239	50V,100MA,300MW,0,0,	1	TRANSISTOR
QM5	2017227	-40V,-100MA,0W,120,0,	1	TRANSISTOR
QM7	2017242	50V,3A,1.5W,140,400,	1	TRANSISTOR
QM8	2021651	-50V,-2A,0.65W,0,0,	1	TRANSISTOR
Q1	X306271209	50V 150MA 150MW	1	TRANSISTOR
Q2	2013876	-50V,-500MA,150MW,70,24	1	TRANSISTOR
Q7-Q8	2017235	50V,100MA,200MVA,0,0,	2	TRANSISTOR
RM10-RM11	2021627	TP,3.3KOHM,1/16W,+5%,	2	CHIP RESISTOR ARRAY
RM13-RM18	2021621	TP,470OHM,1/10W,+5%,	6	CHIP RESISTOR ARRAY
RM19-RM21	2021624	TP,100OHM,1/10W,+5%,	3	CHIP RESISTOR ARRAY
RM2-RM22	2021630	TP,10KOHM,1/16W,+5%,	2	CHIP RESISTOR ARRAY
RM24	2021621	TP,470OHM,1/10W,+5%,	1	CHIP RESISTOR ARRAY
RM4-RM5	2021627	TP,3.3KOHM,1/16W,+5%,	2	CHIP RESISTOR ARRAY
RM6-RM7	2021626	TP,1KOHM,1/16W,+5%,	2	CHIP RESISTOR ARRAY
RM8-RM9	2021627	TP,3.3KOHM,1/16W,+5%,	2	CHIP RESISTOR ARRAY
R1-R4-R6	X193011032	10K OHM 1/10W 5%	3	CHIP RESISTOR ERJ-6GEYJ103V
R10-R11	2017916	BL,0.470HM,1W,+2%,	2	METAL OXIDE FILM RESISTOR
R101	X193011022	1K OHM 1/10W 5%	1	CHIP RESISTOR ERJ-6GEYJ102V
R102	X193011032	10K OHM 1/10W 5%	1	CHIP RESISTOR ERJ-6GEYJ103V
R103-R112	X193011032	10K OHM 1/10W 5%	2	CHIP RESISTOR ERJ-6GEYJ103V
R104-R105	2001519	68 OHM 1/10W 5%	2	CHIP RESISTOR
R106	2001519	68 OHM 1/10W 5%	1	CHIP RESISTOR
R108	2019184	TP,1.27KOHM,1/10W,+1%,	1	CHIP RESISTOR
R111	2004270	TP,1OHM,1/10W,+5%,	1	CHIP RESISTOR
R113-R115	2001529	2.2K OHM 1/10W 5%	2	CHIP RESISTOR
R12-R13	X193011022	1K OHM 1/10W 5%	2	CHIP RESISTOR ERJ-6GEYJ102V
R15	2005470	56K OHM 1/10W 5%	1	CHIP RESISTOR

ESP0522/2

EPSON STYLUS COLOR 300

REF	PART NO	STANDARD	QTY	DESCRIPTION
R16	2016946	TP,22.1OHM,1/10W,+1%,	1	CHIP RESISTOR
R17	2004033	121 OHM 1/10W 1% TP	1	CHIP RESISTOR
R18	2021395	TP,37.4KOHM,1/10W,+1%,	1	CHIP RESISTOR
R19-R20	2018192	TP,523OHM,1/10W,+1%,	2	CHIP RESISTOR
R21	2009983		1	CHIP RESISTOR
R22-R37	2016963	TP,1.6KOHM,1/10W,+5%,	2	CHIP RESISTOR
R23-R25	2015009	TP,16KOHM,1/10W,+5%,	2	CHIP RESISTOR
R24	2001620	24.9K OHM 1/10W 1%	1	CHIP RESISTOR
R26	2005305	820 OHM	1	CHIP RESISTOR
R3-R116	2004793	TP,300OHM,1/10W,+5%,	2	CHIP RESISTOR ERJ-6GEYJ301V
R30	X194601822	18.2K OHM 1/10W 1%	1	CHIP RESISTOR
R31	2019312	TP,1.96KOHM,1/10W,+1%,	1	CHIP RESISTOR
R32	2011796	TP,4.02KOHM,1/10W,+1%,	1	CHIP RESISTOR
R33	2016956	TP,39KOHM,1/10W,+1%,	1	CHIP RESISTOR
R34	2008474	2.26K OHM 1/10W 1%	1	CHIP RESISTOR
R35	X130221216	120 OHM 2W 5%	1	METAL OXIDE FILM RESISTOR
R36	2015009	TP,16KOHM,1/10W,+5%,	1	CHIP RESISTOR
R38	2005302	3.9K OHM	1	CHIP RESISTOR
R39-R42	X193011032	10K OHM 1/10W 5%	2	CHIP RESISTOR ERJ-6GEYJ103V
R40-R94	2017942	BL,0.82OHM,1/2W,+2%,	2	METAL FILM RESISTOR
R41-R50	2001532	5.6K OHM 1/10W 5%	2	CHIP RESISTOR
R44-R45	X193011032	10K OHM 1/10W 5%	2	CHIP RESISTOR ERJ-6GEYJ103V
R46-R91	2001529	2.2K OHM 1/10W 5%	2	CHIP RESISTOR
R47-R114	2001526	680 OHM 1/10W 5%	2	CHIP RESISTOR
R48-R49	X193011032	10K OHM 1/10W 5%	2	CHIP RESISTOR ERJ-6GEYJ103V
R5	2001541	1M OHM 1/10W 5%	1	CHIP RESISTOR
R51	2001536	20K OHM 1/10W 5%	1	CHIP RESISTOR
R52	2008955	200 OHM 1/4W 5%	1	CHIP RESISTOR
R53-R54	X193011032	10K OHM 1/10W 5%	2	CHIP RESISTOR ERJ-6GEYJ103V
R55	2008778	120K OHM 1/10W 1%	1	CHIP RESISTOR
R56	2008478	4.7K OHM 1/10W 1%	1	CHIP RESISTOR
R58	2001613	2.55K OHM 1/10W 1%	1	CHIP RESISTOR
R59-R96	2008817	1K OHM 1/10W 5%	2	CHIP RESISTOR
R60	2014640	TP,1.74KOHM,1/10W,+1%,	1	CHIP RESISTOR
R61	X194601581	1.58K OHM 1/10W 5%	1	CHIP RESISTOR
R67	2001517	47 OHM 1/10W 5%	1	CHIP RESISTOR
R68-R69	2001520	100 OHM 1/10W 5%	2	CHIP RESISTOR
R70-R71	2001520	100 OHM 1/10W 5%	2	CHIP RESISTOR
R72	2016935	TP,1.09KOHM,1/4W,+5%,	1	CHIP RESISTOR
R73-R75	2008295	300 OHM	3	CHIP RESISTOR
R76	2001531	3.3 OHM 1/10W 5%	1	CHIP RESISTOR
R77	2006215	100 OHM 1/10W 5%	1	CHIP RESISTOR
R79-R90	X193011032	10K OHM 1/10W 5%	2	CHIP RESISTOR ERJ-6GEYJ103V
R8-R9-R14	2005470	5.6K OHM 1/10W 5%	3	CHIP RESISTOR
R80	X194601002	10K OHM 1/16W 1%	1	CHIP RESISTOR
R82-R85	X193011032	10K OHM 1/10W 5%	2	CHIP RESISTOR ERJ-6GEYJ103V
R86-R87	X193011032	100K OHM 1/10W 5%	2	CHIP RESISTOR
R88-R107	2001520	100 OHM 1/10W 5%	2	CHIP RESISTOR
R92-R93	X193011022	1K OHM 1/10W 5%	2	CHIP RESISTOR ERJ-6GEYJ102V
R95	X194602102	21K OHM 1/10W 1%	1	CHIP RESISTOR
R97	2017890	TP,2.05KOHM,1/10W,+1%,	1	CHIP RESISTOR
R98-R100	X193011032	10K OHM 1/10W 5%	3	CHIP RESISTOR ERJ-6GEYJ103V
SW1-SW2	2017988	5,15V,20MA,	2	SWITCH
250	2017189		1	BOARD ASSY., I/F
300	2024562	120V	1	BOARD ASSY., POWER SUPPLY
300	2024563	220V/240V	1	BOARD ASSY., POWER SUPPLY
400	2002364	230V	1	POWER CABLE (VD31303SA-10A)
400	2002365	220V	1	POWER CABLE VD00303SA-10A
400	2006741	240V	1	POWER CABLE (BS31303SA-SR-10A)
400	2008768	220V	1	POWER CABLE EHK
400	2010468	240V	1	AC CABLE

EPSON STYLUS COLOR 300

Page 4 of 8

REF	PART NO	STANDARD	QTY	DESCRIPTION
330	2018603		1	WIRE HARNESS
331	2018052		1	HARNESS
400	2018028	220V/230V/240V	1	HARNESS
400	2018054	120V	1	POWER CABLE ASSY.
400	2018055	110V	1	POWER CABLE ASSY.
500	2025432	M-4C12	1	PRINTER MECH.(ASP) W/O PRINT HEAD
501	1024297		1	PULLEY ASSY., DRIVEN
502	1023899		1	FRAME, BASE
503	2017754	0V,0A,0W,	1	DETECTOR, PE
504	1029912		1	FRAME, LEFT;B
505	1023909		1	FRAME, FRONT
506	1023907		1	FRAME, RIGHT
507	1035101		1	CARIDGE ASSY
512	1023906		1	HOLDER, HEAD CABLE
513	1023952		1	HOLDER, PAD, HEAD CABLE
514	1023953		1	COMPRESSION SPRING, 16.11
515	F061001	SINGLE COMPOSITE HEAD	1	PRINT HEAD, IJ64-0E0(ASP), INC. 615, 617
517	1023954		1	LEVER, LOCATE, CARRIAGE
518	1023955		1	SLIDER
519	1024032		1	OIL PAD
520	1024050		1	HEAD CABLE ASSY
521	1024051		1	PAD, HEAD CABLE
522	2021349		1	FERRITE CORE
524	1024047		1	TIMING BELT
525	1024000		4	PAPER GUIDE, UPPER
526	1024887		16	PAPER GUIDE, SUPPORT, UPPER
527	1024192		1	PAPER GUIDE, LEFT
528	1031417		1	PAPER GUIDE, FRONT
529	1024041		6	STARWHEEL ASSY.
530	1024005		6	ROD SPRING, STARWHEEL
531	1028670		1	ROLLER ASSY., EJECT OUT;B
532	1024885		1	ROLLER ASSY., SUPPORT, EJECT OUT
533	1028620		1	LEVER ASSY., EJ;B
534	1035100		1	ROLLER, PF
535	2017757		1	HARNESS, HP
536	2021833	4V,50MA,100MW,	1	DETECTOR, HP;C
537	2022883		1	HARNESS, HP
538	1023917		1	MOUNTING PLATE, DETECTOR, HP
539	1030256		1	FRAME ASSY., PF;B
540	1023902		1	SHAFT, CR, GUIDE
541	2017756	DC5V/2.4W	1	MOTOR ASSY., CR
542	1023958		1	MOUNTING PLATE, CR MOTOR
544	1024045		1	ROLLER ASSY., EJ
545	1024302		1	ROLLER ASSY., LD
548	1023999		4	ROLLER, DRIVEN
549	1025749		1	CLAMP, PULLEY, DRIVEN
550	1024017		1	LEVER, TRIGGER
551	1028109		1	CLEANER, HEAD, ASP;B
552	1024749		1	HOLDER, PE
553	1023986		1	HOLDER, PULLEY, DRIVE
554	1023982		1	HOLDER, GUIDE PLATE
555	1024881		1	SHEET, CLUTCH
556	1035132		1	FRAME, ASSY, CAP;C
557	1023983		1	GUIDE PLATE, FRONT
558	1023984		1	GUIDE PLATE, REAR
559	1023921		1	BUSHING PARALLEL ADJUST, RT
560	1023936		1	BUSHING PARALLEL ADJUST, L.
561	1023904		1	LEVER, PG, UPPER
562	1023905		1	LEVER, PG, LOWER
563	1023980		1	BUSHING, LEVER, CHANGE
564	1029263		1	ROD SPRING, LEVER, CHANGE;B

ESP0522/4

EPSON STYLUS COLOR 300

REF	PART NO	STANDARD	QTY	DESCRIPTION
565	1023989		1	FRAME, FASTEN, GEAR
566	1023990		1	ROD, FASTEN, CAM
567	1023991		1	LEVER, FASTEN, CAM
568	1023992		1	SHAFT, FASTEN, CAM
569	1024034		1	LEVER, CHANGE
570	1024048		1	FLANGE, PULLEY, DRIVE
571	1024035		1	SHIELDPLATE, M/B
572	1024206		1	SHIELD PLATE, P/S, FRONT
573	1024015		1	CLUTCH
574	1025923		1	PAD, PRESSING PLATE, HEAD
576	1023995		1	SPUR GEAR, 8
577	1023997		1	SPUR GEAR, 18
578	1024003		1	SPUR GEAR, 10.8
579	1024004		1	SPUR GEAR, 19
580	1024014		1	SPUR GEAR, 20
581	1025049		1	SPUR GEAR, 6.4
582	1025129		1	SPUR GEAR, 10.8
583	1023979		1	COMPRESSION SPRING, 0.265
584	1024001		4	TORSION SPRING, 856.4
585	1024016		1	EXTENSION SPRING, 0.698
586	1024018		1	TORSION SPRING, 216.6
587	1024733		1	COMPRESSION SPRING, 14.70
588	1024735		1	TORSION SPRING, 867.79
590	1025705		1	COMPRESSION SPRING, 1.764
591	1025706		1	COMPRESSION SPRING, 3.9
599	B100168690	10.3X0.5X18.7	1	PLAIN WASHER
600	1024878		1	PLAIN WASHER, 10.2X0.5X12.6
601	1024894		1	PLAIN WASHER, 6.7X0.5X12.2
602	B101254590	6.2X0.15X11	1	LEAF SPRING
603	1024207	10.3X0.25X17, S/NA	1	U-TYPE SPRING WASHER,
604	1023998		3	BUSHING, 10
605	B010103411	M3X8	1	C.P.SCREW
606	B010103611	M3X12	1	C.P.SCREW
607	B010403311	M3X6	1	C.F.SCREW
608	B300204211	M3X6	17	C.B.S. SCREW
609	1024892		1	C.P.B.(O) SCREW, 1.7X5, F/ZN
610	1001686	4.1X0.5X8	1	CUT WASHER
611	B150300911	TYPE F(6)	1	RETAINING RING
612	B150301011	TYPE F(5)	1	RETAINING RING
613	X522000010		1	WIRE BAND
614	1024505		3	HEXAGON NUT, NORMAL, M3
615	1035098		1	LEVER, CARTRIDGE, 4C
617	1024829		1	POROUS PAD, HEAD;YMC
619	1024033		1	PRESSING PLATE, OIL PAD
623	1031416		6	ROD SPRING, STARWHEEL;B
625	202023	DC42V/0.5A/21W	1	MOTOR ASSY., PF
END				
		NO PACKING ITEMS LISTED.		

EPSON STYLUS COLOR 300

Page 6 of 8

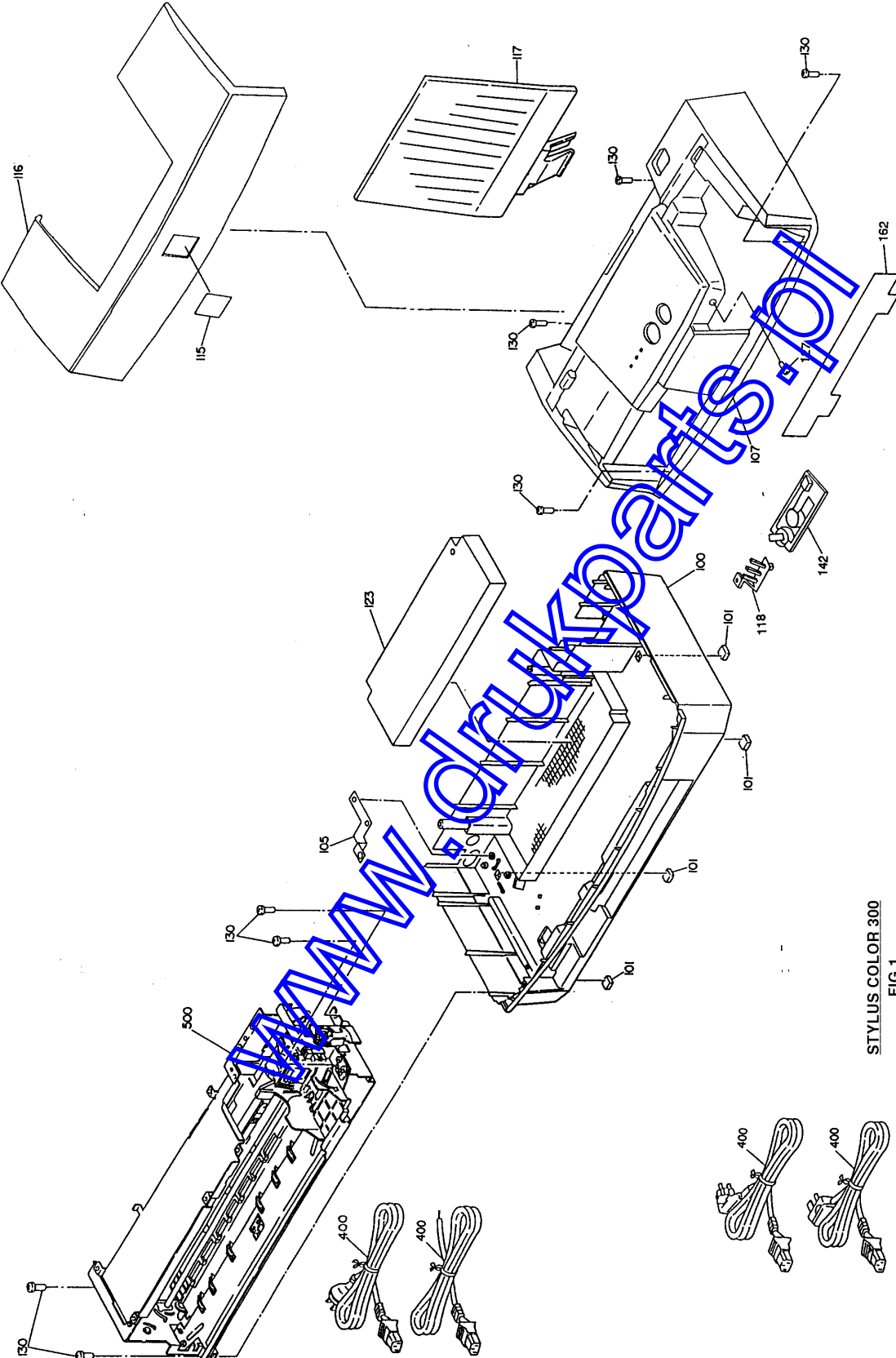

STYLUS COLOR 300
FIG. 1
Page 6 of 8

EPSON STYLUS COLOR 300

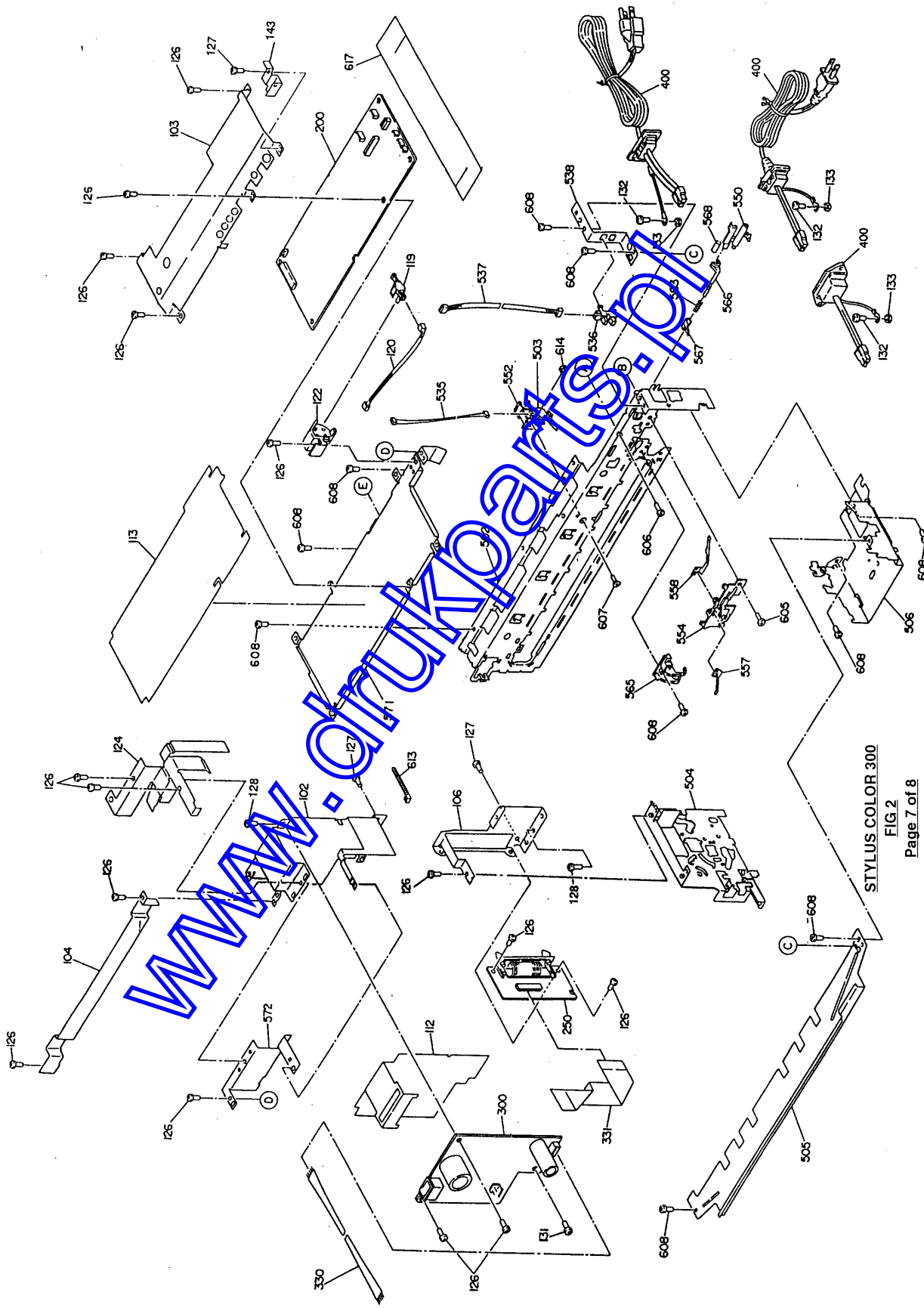

STYLUS COLOR 300
FIG. 2
Page 7 of 8

EPSON STYLUS COLOR 300

Page 8 of 8

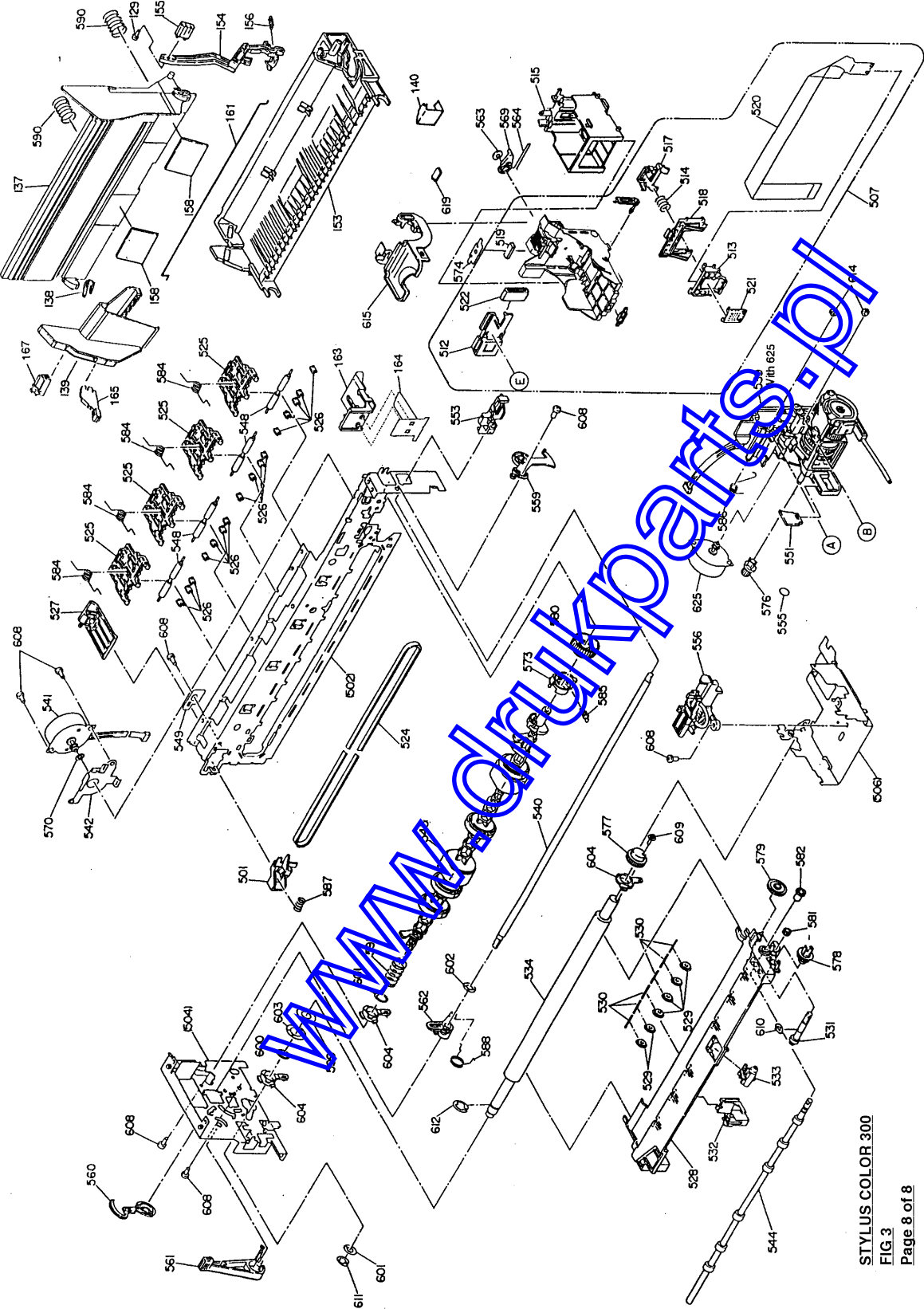

STYLUS COLOR 300
FIG. 3
Page 8 of 8