

EPSON STYLUS 200

Page 3 of 14

| REF | PART NO. | DESCRIPTION | QTY | REMARKS |
|-----------|------------|------------------------|-----|------------------------|
| 200 | 2021835 | BOARD ASSY. MAIN | 1 | |
| IC3 | 2022622 | P-ROM TDC07 | 1 | 4M BIT |
| CN1 | 2005881 | CONNECTOR | 1 | 21 PIN |
| CN3 | X600440410 | CONNECTOR | 1 | 4 PIN |
| CN4 | 2018248 | CONNECTOR | 1 | 19 |
| CN5 | 2017929 | CONNECTOR | 1 | 4 |
| CN6 | 2017149 | CONNECTOR | 1 | 5 |
| CN7 | X600440120 | CONNECTOR | 1 | 2 PIN |
| CN8 | X600440310 | CONNECTOR | 1 | 3 PIN |
| CN9 | 2003678 | CONNECTOR | 1 | 2 |
| CR1 | 2022140 | CERAMIC OSCILLATOR | 1 | 5.52MHZ |
| CR2 | 2021879 | CERAMIC OSCILLATOR | 1 | 25MHZ |
| C1 C5 C28 | 2002486 | CHIP CAPACITOR | 6 | 0.1UF DC25V +80% -20% |
| C10 | X271122221 | CHIP CAPACITOR | 1 | 220PF DC50V 10% |
| C11 | 2021880 | CHIP CAPACITOR | 1 | TP 470PF 50V |
| C12 | 2014921 | ALUM. ELYTIC CAP. | 1 | TP 220UF 50V +-20% |
| C14 C18 | 2002486 | CHIP CAPACITOR | 5 | 0.1UF DC25V +80% -20% |
| C19 C59 | X281323301 | CHIP CAPACITOR | 3 | 33PF 50V 5% |
| C20 C22 | 2002486 | CHIP CAPACITOR | 3 | 0.1UF DC25V +80% -20% |
| C23 C51 | X271124711 | CHIP CAPACITOR | 2 | 470PF 50V 10% |
| C29 C39 | 2002486 | CHIP CAPACITOR | 2 | 0.1UF DC25V +80% -20% |
| C30 C34 | X271121021 | CHIP CERAMIC CAPACITOR | 3 | 1000PF DC50V 10% |
| C31 C33 | 2002486 | CHIP CAPACITOR | 3 | 0.1UF DC25V +80% -20% |
| C35 | 2017933 | ALUM. ELYTIC. CAP. | 1 | TP 220UF 10V +-20% |
| C36 C37 | 2018119 | ALUM. ELYTIC. CAP. | 2 | BL 100UF 50V +-20% |
| C38 C53 | X281323301 | CHIP CAPACITOR | 2 | 33PF 50V 5% |
| C40 | 2002487 | CHIP CAPACITOR | 1 | 0.01UF 50V 10% |
| C41 C43 | X271124711 | CHIP CAPACITOR | 3 | 470PF 50V 10% |
| C44 C45 | 2002500 | CHIP CAPACITOR | 2 | TP 4700PF 50V +-1 |
| C46 C50 | X281323301 | CHIP CAPACITOR | 5 | 33PF 50V 5% |
| C52 C54 | 2002486 | CHIP CAPACITOR | 2 | 0.1UF DC25V +80% -20% |
| C55 C57 | 2002486 | CHIP CAPACITOR | 2 | 0.1UF DC25V +80% -20% |
| C58 C65 | 2002486 | CHIP CAPACITOR | 2 | 0.1UF DC25V +80% -20% |
| C6 C7 C13 | X271124711 | CHIP CAPACITOR | 3 | 470PF 50V 10% |
| C60 C61 | X271124711 | CHIP CAPACITOR | 2 | 470PF 50V 10% |
| C63 C64 | X281323301 | CHIP CAPACITOR | 2 | 33PF 50V 5% |
| C8 C9 | 2003503 | CHIP CAPACITOR | 2 | TP 3300PF 50V +-10% |
| D1 D10 | 2014230 | DIODE | 2 | 80V 100MA 0MW |
| D11 | 2014230 | DIODE | 1 | 80V 100MA 0MW |
| D2 D9 | 2004113 | SHOT KEY | 1 | -50V 500MA |
| IC1 | 2022297 | GATE ARRAY E05B32KB | 1 | 50V 500MA |
| IC10 | 2014681 | EEPROM | 1 | SOP 1K BIT 8 |
| IC11 | X422350079 | RELAY | 1 | HEX BUF/DRV OC HI-VOCT |
| IC13 | 2009451 | RESET IC | 1 | SOP 4 |
| IC15 | X440004314 | VOLTAGE REGULATOR IC | 1 | SHUNT REGULATOR UPAK |
| IC16 | 2018007 | IC | 1 | |
| IC2 | 2021874 | MICROCOMPUTER | 1 | 100 PIN |
| IC3 | X630114230 | IC SOCKET | 1 | 42 PIN |
| IC4 | 2015936 | PSRAM | 1 | |
| IC6 | 2020754 | MASK ROM M80A78JA | 1 | 8M BIT |
| IC8 | 2017973 | HIC UDN2917EB-TR | 1 | |
| IC9 | 2007915 | RESET IC | 1 | 8 PIN |
| LED1 LED2 | 2021878 | CHIP LED | 2 | 0V 0MA 0MW |
| LED3 | 2021877 | CHIP LED | 1 | 0V 0MA 0MW |
| QM1 QM6 | 2017228 | TRANSISTOR | 2 | 40V 100MA 0W 120 0 |
| QM2 QM3 | 2017885 | TRANSISTOR | 2 | 50V 100MA 0W 0 0 |
| QM4 | 2017239 | TRANSISTOR | 1 | 50V 100MA 300MW 0 0 |
| QM5 | 2017227 | TRANSISTOR | 1 | -40V -100MA 0W 120 0 |
| QM7 | 2017242 | TRANSISTOR | 1 | 50V 3A 1.5W 140 400 |

ESP0507/3

EPSON STYLUS 200

Page 6 of 14

| REF | PART NO. | DESCRIPTION | QTY | REMARKS |
|-----|----------|--------------------------------|-----|---------------|
| 250 | 2017189 | BOARD ASSY. I/F | 1 | |
| 300 | 2018212 | BOARD ASSY. P/ S 120V | 1 | |
| 300 | 2018213 | BOARD ASSY. P/ S 220V/240V | 1 | |
| 400 | 2002364 | POWER CABLE (VD31303SA-10A) | 1 | 230V |
| 401 | 2006741 | POWER CABLE (BS31303SA-SR-10A) | 1 | 240V |
| 402 | 2010468 | AC CABLE | 1 | 240V |
| 403 | 2002365 | POWER CABLE VD00303SA-10A | 1 | 220V |
| 403 | 2008768 | POWER CABLE | 1 | 220V |
| 330 | 2018603 | WIRE HARNESS | 1 | |
| 331 | 2018052 | HARNESS | 1 | |
| 410 | 2018054 | POWER CABLE ASSY. | 1 | |
| 411 | 2018055 | POWER CABLE ASSY. | 1 | |
| 412 | 2018028 | HARNESS | 1 | |
| 500 | 2022404 | PRINTER MECHANISM | 1 | M-4C11 |
| 501 | 1024297 | PULLEY ASSY. DRIVEN | 1 | |
| 502 | 1023899 | FRAME BASE | 1 | |
| 503 | 2017754 | DETECTOR PE | 1 | 07.05.01 |
| 504 | 1029912 | FRAME LEFT;B | 1 | |
| 505 | 1023909 | FRAME FRONT | 1 | |
| 506 | 1023907 | FRAME RIGHT | 1 | |
| 507 | 1024300 | CARRIAGE ASSY. | 1 | |
| 508 | 1024301 | CARRIAGE SUB ASSY. | 1 | |
| 509 | 1023957 | LEVER ADJUST HEAD | 1 | |
| 510 | 1024031 | SLIDER CARRIAGE | 1 | |
| 511 | 1027219 | LEVER ASSY. FASTEN HEAD | 1 | |
| 512 | 1023906 | HOLDER HEAD CABLE | 1 | |
| 513 | 1023952 | HOLDER PAD HEAD CABLE | 1 | |
| 514 | 1023953 | COMPRESSION SPRING 16.11 | 1 | |
| 516 | F047001 | PRINT HEAD IJ64-0CA | 1 | BLACK |
| 517 | 1023954 | LEVER LOCATE CARRIAGE | 1 | |
| 518 | 1023955 | SLIDER | 1 | |
| 519 | 1024032 | OIL PAD | 1 | |
| 520 | 1024050 | HEAD CABLE ASSY. | 1 | |
| 521 | 1024051 | PAD HEAD CABLE | 1 | |
| 522 | 2021349 | FERRITE CORE | 1 | |
| 524 | 1024047 | TIMING BELT | 1 | |
| 525 | 1024000 | PR GUIDE UPPER | 4 | |
| 526 | 1024887 | PR GUIDE SUPPORT UPPER | 6 | |
| 527 | 1024192 | PR GUIDE LEFT | 1 | |
| 528 | 1024002 | PR GUIDE FRONT | 1 | |
| 529 | 1024041 | STAR WHEEL | 6 | |
| 530 | 1024005 | ROD SPRING STAR WHEEL | 6 | |
| 531 | 1028670 | ROLLER ASSY. EJECT OUT;B | 1 | |
| 532 | 1024885 | ROLLER ASSY. SUPPORT EJECT OUT | 1 | |
| 533 | 1028620 | LEVER ASSY. EJ;B | 1 | |
| 534 | 1024046 | ROLLER | 1 | |
| 535 | 2017757 | HARNESS HP | 1 | |
| 536 | 2021833 | DETECTOR HP;C | 1 | 4V 50MA 100MW |
| 537 | 2017757 | HARNESS HP | 1 | |
| 538 | 1023917 | MOUNTING PLATE DETECTOR HP | 1 | |
| 539 | 1030256 | FRAME ASSY. PF;B | 1 | |
| 540 | 1023902 | SHAFT CR GUIDE | 1 | |
| 541 | 2017756 | MOTOR ASSY. CR | 1 | 2.4W |
| 542 | 1023958 | MOUNTING PLATE CR MOTOR | 1 | |
| 544 | 1024045 | ROLLER ASSY. EJ | 1 | |
| 545 | 1024302 | ROLLER ASSY. LD | 1 | |
| 548 | 1023999 | ROLLER DRIVEN | 4 | |
| 549 | 1025749 | CLAMP PULLEY DRIVEN | 1 | |

ESP0507/6

EPSON STYLUS 200

Page 7 of 14

| REF | PART NO. | DESCRIPTION | QTY | REMARKS |
|-----|------------|-----------------------------|-----|---------------|
| 550 | 1024017 | LEVER TRIGGER | 1 | |
| 551 | 1028109 | CLEANER HEAD ASP;B | 1 | |
| 552 | 1024749 | HOLDER PE | 1 | |
| 553 | 1023986 | HOLDER PULLEY DRIVE | 1 | |
| 554 | 1023982 | HOLDER GUIDE PLATE | 1 | |
| 555 | 1024881 | SHEET CLUTCH | 1 | |
| 556 | 1030258 | FRAME ASSY. CAP;B | 1 | |
| 557 | 1023983 | GUIDE PLATE FRONT | 1 | |
| 558 | 1023984 | GUIDE PLATE REAR | 1 | |
| 559 | 1023921 | BUSHING P'LLELISM ADJUST RT | 1 | |
| 560 | 1023936 | BUSHING P'LLELISM ADJUST LT | 1 | |
| 561 | 1023904 | LEVER PG UPPER | 1 | |
| 562 | 1023905 | LEVER PG LOWER | 1 | |
| 563 | 1023980 | BUSHING LEVER CHANGE | 1 | |
| 564 | 1029263 | ROD SPRING LEVER CHANGE;B | 1 | |
| 565 | 1023989 | FRAME FASTEN GEAR | 1 | |
| 566 | 1023990 | ROD FASTEN CAM | 1 | |
| 567 | 1023991 | LEVER FASTEN CAM | 1 | |
| 568 | 1023992 | SHAFT FASTEN CAM | 1 | |
| 569 | 1024034 | LEVER CHANGE | 1 | |
| 570 | 1024048 | FLANGE PULLEY DRIVE | 1 | |
| 571 | 1024035 | SHIELDPLATE M/B | 1 | |
| 572 | 1024206 | SHIELD PLATE P/S FRONT | 1 | |
| 573 | 1024015 | CLUTCH | 1 | |
| 574 | 1025923 | PAD PRESSING PLATE HEAD | 1 | |
| 576 | 1023995 | SPUR GEAR 8 | 1 | |
| 577 | 1023997 | SPUR GEAR 18 | 1 | |
| 578 | 1024003 | SPUR GEAR 10.8 | 1 | |
| 579 | 1024004 | SPUR GEAR 19.2 | 1 | |
| 580 | 1024014 | SPUR GEAR 20.8 | 1 | |
| 581 | 1025049 | SPUR GEAR 6.4 | 1 | |
| 582 | 1025129 | SPUR GEAR 10.8 | 1 | |
| 583 | 1023979 | COMPRESSION SPRING 0.265 | 1 | |
| 584 | 1024001 | TORSIONSPRING 85.14 | 4 | |
| 585 | 1024016 | EXTENSION SPRING 0.698 | 1 | |
| 586 | 1024018 | TORSION SPRING 216.6 | 1 | |
| 587 | 1024733 | COMPRESSION SPRING 14.70 | 1 | |
| 588 | 1024735 | TORSION SPRING 57.79 | 1 | |
| 590 | 1025705 | COMPRESSION SPRING 1.764 | 2 | |
| 591 | 1025706 | COMPRESSION SPRING 3.9 | 1 | |
| 599 | B100168690 | PLAIN WASHER | 1 | 10.3X0.5X18.7 |
| 600 | 1024878 | PLAIN WASHER 10.2X0.5X12.6 | 1 | |
| 601 | 1024894 | PLAIN WASHER 6.7X0.5X12.2 | 1 | |
| 602 | B101254590 | LEAF SPRING | 1 | 6.2X0.15X11 |
| 603 | 1024207 | PLAIN WASHER 10.3X0.25X17 S | 1 | |
| 604 | 1023998 | BUSHING 10 | 3 | |
| 605 | B010103411 | C.P.SCREW | 1 | M3X8 |
| 606 | B010103611 | C.P.SCREW | 1 | M3X12 |
| 607 | B010403311 | C.F.SCREW | 1 | M3X6 |
| 608 | B300204211 | C.B.S. SCREW | 17 | M3X6 |
| 609 | 1024892 | C.P.B.(O) SCREW 1.7X5 F/ZN | 1 | |
| 610 | 1001686 | CUT WASHER | 1 | 4.1X0.5X8 |
| 611 | B150300911 | RETAINING RING | 1 | TYPE-E(6) |
| 612 | B150301011 | RETAINING RING | 1 | TYPE-E(7) |
| 613 | X522000010 | WIRE BAND | 1 | |
| 614 | 1024505 | HEXAGON NUT NORMAL M3 | 3 | |
| 616 | 1024830 | LEVER CARTRIDGE;BK | 1 | |
| 618 | 1024828 | POROUS PAD HEAD;BK | 1 | |
| 619 | 1024033 | PRESSING PLATE OIL PAD | 1 | |

ESP05077

EPSON STYLUS 200

Page 10 of 14

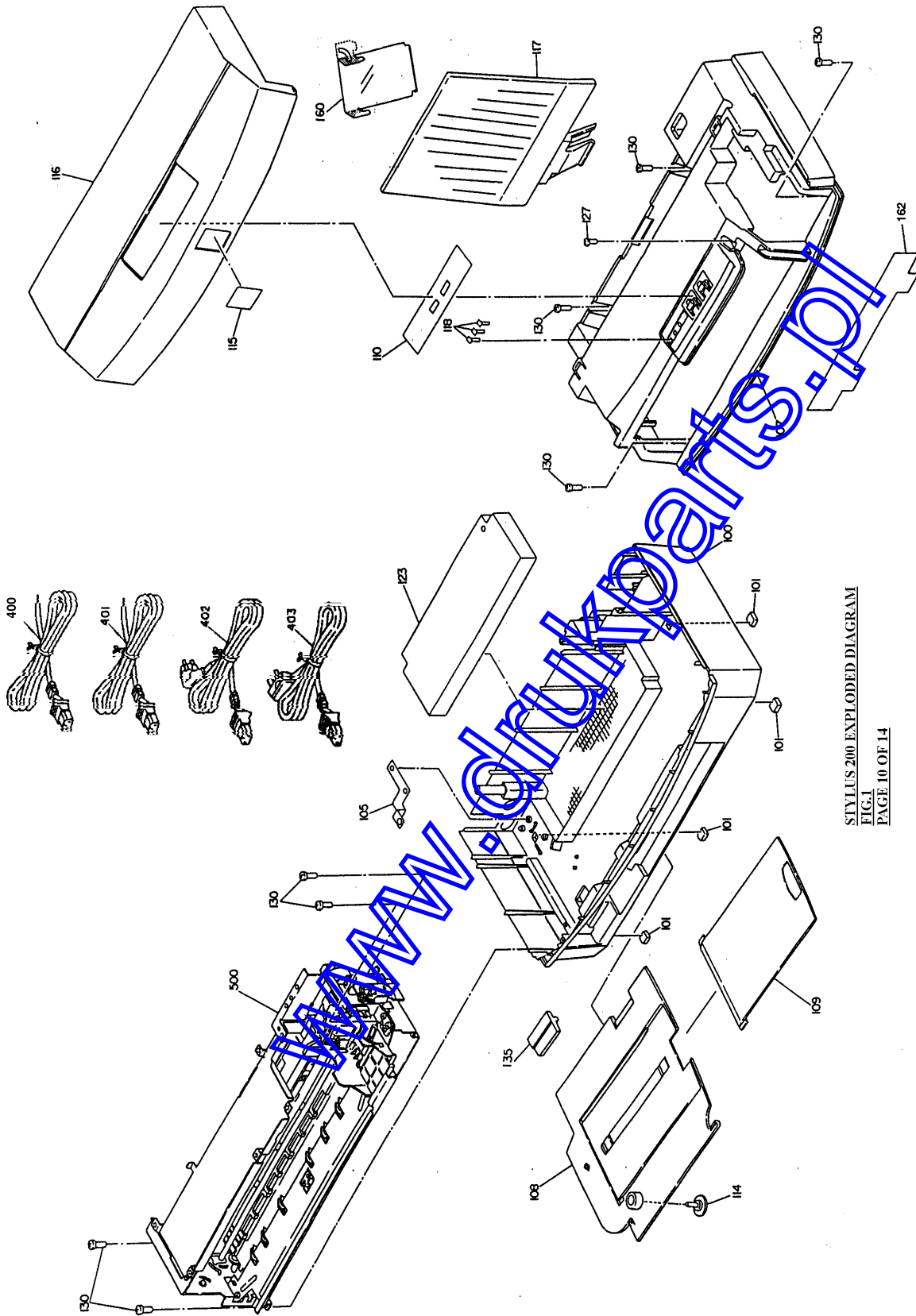

STYLUS 200 EXPLODED DIAGRAM
FIG.1
PAGE 10 OF 14

EPSON STYLUS 200

Page 12 of 14

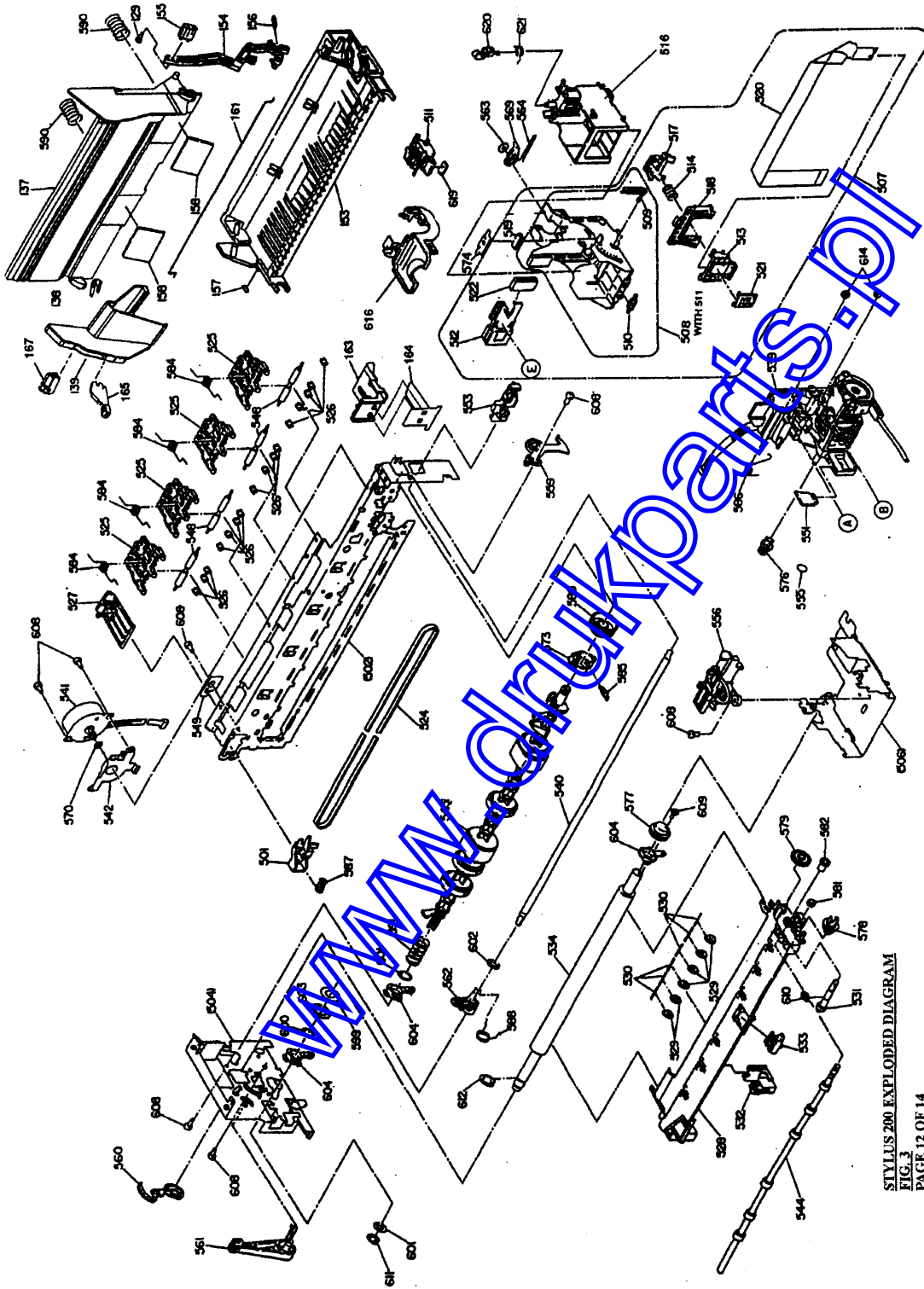

STYLUS 200 EXPLODED DIAGRAM
FIG. 3
PAGE 12 OF 14