

EPSON DLQ3000PLUS

Page 1

REF	PART NO	DESCRIPTION	REMARKS	QTY
100	1033987	HOUSING ASSY., LOWER		1
102	1033832	COVER, SEALED, REAR		1
103	1033988	HOUSING ASSY., UPPER		1
104	B310204411	C.B.B. SCREW	M3X10	12
105	1033813	CAP, G, ADJUST		1
106	1033984	FRAME ASSY., BOTTOM		1
107	F344551030	RUBBER FOOT		4
108	1033838	SEALED PLATE		1
109	1020295	KNOB		1
110	1022576	COVER ASSY., PRINTER		1
111	1016917	SHEET GUIDE ASSY., REAR		1
112	1033840	COVER, PG SWITCH		1
113	1033990	SHEET GUIDE ASSY., FRONT		1
114	1002044	COVER, REAR		1
115	1002045	COVER, CONNECTOR, UPPER		1
116	1033841	MOUNTING PLATE, CONNECTOR, CSF		1
117	1002047	GROUNDING PLATE		2
118	1002048	LEVER, RELEASE		1
119	2011968	INTER LOCK ASSY.		1
120	1037586	LOGO PLATE;B		1
121	1002451	GROUNDING PLATE, P.C.B.		1
122	1033843	GROUNDING PLATE		1
123	1002096	C.B.B. SCREW	M3X40	1
124	1002097	C.B.S. SCREW	M3X12	2
125	1033847	GROUNDING, CONNECTOR, CSF		1
126	2024253	PRINTED CIRCUIT BOARD, ASSEMBLY, PG		1
127	1036387	SEAT, SLIDE, SWITCH		1
128	1008508	C.B.S. SCREW	M2.5X8	3
129	B310204518	C.B.B.SCREW	M3X12	2
130	B310206611	C.B.B. SCREW	M4X16	6
131	B313306811	C.B.B.(P) SCREW	M4X25	4
132	B300204311	C.B.S. SCREW	M3X8	1
200	2024223	BOARD ASSY., MAIN & SUB - STD		1
200	2024780	BOARD ASSY., MAIN & SUB- NLSP		1
201	B300204211	C.B.S. SCREW	M3X6	13
203	1006374	GUIDE IN BOARD		1
204	1016572	EARTH SPRING;B		1
205	1017041	FRAME, MAIN		1
206	1017042	GROUNDING PLATE, I/F		1
207	1017044	INSULATION PLATE, MAIN		1
208	1017046	SHIELD CASE, TYPE B		1
209	2011447	HARNESS		1
210	1003991	HEAT SINK		1
CN1-CN3	2011810	CONNECTOR	20,	3
CN10	X601110400	CONNECTOR	4 PIN	1
CN11	X601110600	CONNECTOR	6 PIN	1
CN12	X601110610	CONNECTOR	6 PIN	1
CN13	X600441000	CONNECTOR	10 PIN	1
CN14	2011808	CONNECTOR	2,	1
CN21(SUB)	2011810	CONNECTOR	20,	1
CN22(SUB)	2011810	CONNECTOR	20,	1
CN23(SUB)	2011810	CONNECTOR	20,	1
CN24(SUB)	2011812	CONNECTOR	20,	1
CN25(SUB)	2011812	CONNECTOR	20,	1
CN26(SUB)	2011811	CONNECTOR	14,	1
CN27(SUB)	2024304	CONNECTOR	4,	1

EPSON

DLQ3000PLUS

Page 2

REF	PART NO	DESCRIPTION	REMARKS	QTY
CN28(SUB)	X600440120	CONNECTOR	2 PIN	1
CN4	2024305	CONNECTOR	18P	1
CN5	2024306	CONNECTOR	26P	1
CN6	2001155	CONNECTOR	36 PIN	1
CN7	2012956	CONNECTOR		1
CN8	X601110700	CONNECTOR	11 PIN	1
CN9	X600440120	CONNECTOR	2 PIN	1
CR1	2021650	CERAMIC OSILLATOR	14.74MHZ,	1
CR2	2024618	CERAMIC OSCILLATOR	20MHZ,	1
C1-C2-C18	2003619	CHIP CAPACITOR		3
C100	X281326801	CHIP CAPACITOR	68PF 50MV 5%	
C11	2010653	CHIP CAPACITOR	470PF 220V 10%	
C12-C13	X271123911	CHIP CAPACITOR	390PF DC50V 10%	
C14-C16	2003274	CHIP ELECTROLYTIC CAPACITOR		
C15-C17	X271121021	CHIP CERAMIC CAPACITOR	1000PF DC50V 10%	
C19-C22	2003619	CHIP CAPACITOR		2
C20-C21	X271123911	CHIP CAPACITOR	390PF DC50V 10%	2
C23-C24	2013197	ELECTRIC ALMI CAPACITOR	4.7UF 50V	2
C26-C27	2003619	CHIP CAPACITOR		2
C28-C29	X271124711	CHIP CAPACITOR	470PF 50V 10%	2
C3-C8-C10	2010653	CHIP CAPACITOR	470PF 220V 10%	7
C31-C32	X271124711	CHIP CAPACITOR	470PF 50V 10%	2
C33-C37	2002486	CHIP CAPACITOR	0.1UF DC25V +80% -20%	5
C38-C39	2003619	CHIP CAPACITOR		2
C40-C41	2002486	CHIP CAPACITOR	0.1UF DC25V +80% -20%	2
C42	2021166	CHIP CAPACITOR	TP 390PF 50V,+5%,	1
C43-C49	2002487	CHIP CAPACITOR	0.01UF 50V 10%	2
C44-C62	2003619	CHIP CAPACITOR		2
C45	X271122211	CHIP CAPACITOR	220PF 50V 10%	1
C46-C59	X281314701	CHIP CAPACITOR	47PF 50V 5%	2
C47	2002486	CHIP CAPACITOR	0.1UF DC25V +80% -20%	1
C48	X271123911	CHIP CAPACITOR	390PF DC50V 10%	1
C50-C51	2024303	ELECTROLYTIC CAPACITOR	BL,3300UF,50V,+20%,	2
C52-C58	2002486	CHIP CAPACITOR	0.1UF DC25V +80% -20%	7
C60-C61	2002486	CHIP CAPACITOR	0.1UF DC25V +80% -20%	2
C63-C77	2002486	CHIP CAPACITOR	0.1UF DC25V +80% -20%	15
C78-C81	2017590	ELECTROLYTIC CAPACITOR	TP,1UF,50V,+20%,	4
C82	2011982	ELECTRIC ALMI CAPACITOR	22UF 16V	1
C83-C86	2010653	CHIP CAPACITOR	470PF 220V 10%	4
C87-C93	2002487	CHIP CAPACITOR	0.01UF 50V 10%	7
C9-C25-C30	2002486	CHIP CAPACITOR	0.1UF DC25V +80% -20%	3
C94-C97	2010653	CHIP CAPACITOR	470PF 220V 10%	4
C98-C101	2002486	CHIP CAPACITOR	0.1UF DC25V +80% -20%	2
C99	X281312201	CHIP CAPACITOR	22PF 50V 5%	1
DM1	2006090	DIODE ARRAY		1
D1-D55	2013883	DIODE		55
D56	2003592	DIODE	80V 100MA 200MW	1
F1	2011653	FUSE	125V,250A,	1
F2	2014582	FUSE	125V,1A,	1
IC1-IC4	X422350079	TTL-IC	HEX BUF/DRV OC HI-VOCT	4
IC14	2013458	RS-232 TRANSCEIVER IC		1
IC15	2021435	FLASH MEMORY		1
IC16	2014245	MICRO CONTROLLER	16BIT	1
IC17	2011782	IC		1
IC18	X630114030	IC SOCKET	40 PIN	1
IC19	X440034314	IC TL431CLPB(-TZ)	BIPOLAR SWREG T902 TP	1

EPSON DLQ3000PLUS

Page 3

REF	PART NO	DESCRIPTION	REMARKS	QTY
IC20	2024299	RESET IC		1
IC21	X630113230	IC SOCKET	32 PIN	1
IC22	2009451	RESET IC, PST592DMT	SOP 4	1
IC23	2016378	EEP-ROM		1
IC24	2021130	MASK ROM, M40B56PB	4M BIT	1
IC24	2026312	MASK ROM, M80B15JC	KM23C8100D,	1
IC25	2024485	GATE ARRAY, E05B46AB		1
IC26	2024617	D-RAM		1
IC27	X422350079	TTL-IC	HEX BUF/DRV OC HI-VOCT	1
IC5	2005177	TTL-IC		1
IC6	2000592	HYBRID IC SLA7024M		1
IC7	2001152	HYBRID IC		1
QM1	2005275	TRANSISTOR ARRAY, SDC03-V1		1
QM2	2011787	TRANSISTOR ARRAY, MP5302	0V,0A,2W,NPN+PNP	1
QM3-QM4	2013877	TRANSISTOR ARRAY	0V,0A,0W	2
QM5-QM10	2011788	FET ARRAY	10V,1A,0W	6
Q1-Q2	2022324	TRANSISTOR	50V,1.2A,1300MW,1000,0,	2
Q20-Q33	2011784	TRANSISTOR	50V,1.2A,0W,0,0,	14
Q3	2007085	TRANSISTOR	60V 1.2A 1W 2000 12000	1
Q34	2011786	TRANSISTOR	150V,1.5A,0W,0,0,	1
Q35	2014231	TRANSISTOR	50V,100MA,200MW,100,600	1
Q4	2011623	TRANSISTOR	50V,100MA,200MW,100,0,	1
Q5	X306339809	TRANSISTOR	50V 100MA 200MW	1
Q6-Q19	2013876	TRANSISTOR	-50V,-500MA,150MW,70,24	14
RM1-RM6	2021627	CHIP RESISTOR ARRAY	TP,3.3KOHM,1/16W,+5%,	6
RM7-RM8	2023272	CHIP RESISTOR ARRAY	TP,150OHM,1/16W,+5%,	2
RM9-RM22	2021620	CHIP RESISTOR ARRAY	TP,33OHM,1/16W,+5%,	14
R1-R2	X193812012	CHIP RESISTOR	200 OHM 1/8W 5%	2
R10-R11	2001531	CHIP RESISTOR	3.3 OHM 1/10W 5%	2
R102-R125	X193011022	CHIP RESISTOR ERJ-6GEYJ102V	1K OHM 1/10W 5%	24
R12-R26	X120220017	CARBON FILM RESISTOR	1 OHM 2W 5%	2
R127	2001521	CHIP RESISTOR	200 OHM 1/10W 5%	1
R128	2001520	CHIP RESISTOR	100 OHM 1/10W 5%	1
R129-R194	2005213	CHIP RESISTOR	33 OHM 1/10W 5%	2
R13-R27	2011802	CEMENT RESISTOR	BL,0.47OHM,5W,+5%,	2
R130-R132	X193011032	CHIP RESISTOR ERJ-6GEYJ103V	10K OHM 1/10W 5%	3
R133	2005306	CHIP RESISTOR	910 OHM	1
R134-R147	X193815622	CHIP RESISTOR		14
R14	2011647	CHIP RESISTOR	TP,390OHM,1/10W,+5%,	1
R148-R161	2005306	CHIP RESISTOR	910 OHM	14
R15-R71	2005570	CHIP RESISTOR	6.2K OHM 1/10W 5% TP	2
R162-R175	2006298	CHIP RESISTOR	56 OHM	14
R17	X193011032	CHIP RESISTOR ERJ-6GEYJ103V	10K OHM 1/10W 5%	1
R176-R189	2011801	METAL OXIDE FILM RESISTOR	TP,0.51OHM,2W,+5%,	14
R18-R21	X193012022	CHIP RESISTOR	2K OHM 1/10W 5%	4
R190	2013768	CHIP RESISTOR	TP,16.5KOHM,1/10W,+1%,	1
R191-R193	X193011022	CHIP RESISTOR ERJ-6GEYJ102V	1K OHM 1/10W 5%	3
R195	X193014722	CHIP RESISTOR	4.7K OHM 1/10W 5%	1
R196-R207	X193011032	CHIP RESISTOR ERJ-6GEYJ103V	10K OHM 1/10W 5%	2
R197	2001519	CHIP RESISTOR	68 OHM 1/10W 5%	1
R198-R200	2004273	CHIP RESISTOR	TP,150OHM,1/10W,+5%,	3
R201-R203	2001519	CHIP RESISTOR	68 OHM 1/10W 5%	3
R205-R208	2005462	CHIP RESISTOR	33K OHM 1/10W 5% TP	13
R206	X193813922	CHIP RESISTOR	3.9K OHM 1/8W 5%	1
R209	X193011032	CHIP RESISTOR ERJ-6GEYJ103V	10K OHM 1/10W 5%	1

EPSON

DLQ3000PLUS

Page 4

REF	PART NO	DESCRIPTION	REMARKS	QTY
R210	2001517	CHIP RESISTOR	47 OHM 1/10W 5%	1
R211	2002019	CHIP RESISTOR	2.7K OHM 1/10W 1%	1
R212	2011721	CHIP RESISTOR	3.09K OHM 1/10W 1%	1
R213-R214	X193011022	CHIP RESISTOR ERJ-6GEYJ102V	1K OHM 1/10W 5%	2
R215	2001541	CHIP RESISTOR	1M OHM 1/10W 5%	1
R216-R220	X193011022	CHIP RESISTOR ERJ-6GEYJ102V	1K OHM 1/10W 5%	5
R22-R25	X193011032	CHIP RESISTOR ERJ-6GEYJ103V	10K OHM 1/10W 5%	4
R221	2005302	CHIP RESISTOR	3.9K OHM	1
R222	X193011022	CHIP RESISTOR ERJ-6GEYJ102V	1K OHM 1/10W 5%	1
R223-R249	2006284	CHIP RESISTOR	0 OHM	2
R224	X130121016	METAL OXIDE FILM RESISTOR	100 OHM 1W 5%	1
R225-R229	X193011032	CHIP RESISTOR ERJ-6GEYJ103V	10K OHM 1/10W 5%	5
R230-R233	2001520	CHIP RESISTOR	100 OHM 1/10W 5%	1
R234-R239	2005462	CHIP RESISTOR	33K OHM 1/10W 5% TP	1
R240-R243	2001519	CHIP RESISTOR	68 OHM 1/10W 5%	1
R241-R242	2005462	CHIP RESISTOR	33K OHM 1/10W 5% TP	2
R244-R245	2005462	CHIP RESISTOR	33K OHM 1/10W 5% TP	2
R246-R248	2001519	CHIP RESISTOR	68 OHM 1/10W 5%	3
R250	2005462	CHIP RESISTOR	33K OHM 1/10W 5% TP	1
R252	2001532	CHIP RESISTOR	5.6K OHM 1/10W 5%	1
R28-R29	2001530	CHIP RESISTOR	2.4K OHM 1/10W 5%	2
R3-R7-R126	2001532	CHIP RESISTOR	5.6K OHM 1/10W 5%	6
R30	2005469	CHIP RESISTOR	30K OHM	1
R31-R32	2001530	CHIP RESISTOR	14K OHM 1/10W 5%	2
R33-R34	X194605111	CHIP RESISTOR	5.11K OHM 1/10W 1%	2
R35-R38	2001538	CHIP RESISTOR	47K OHM 1/10W 5%	4
R39-R48	2004297	CHIP RESISTOR	TP,1.54KOHM,1/10W,+1%,	2
R40-R49	2017898	CHIP RESISTOR	TP,1.15KOHM,1/10W,+1%,	2
R41-R50	2008961	CHIP RESISTOR	806 OHM 1/10W 1%	2
R42-R51	2024302	CHIP RESISTOR	TP,499OHM,1/10W,+1%,	2
R43-R52	2024300	CHIP RESISTOR	TP,118OHM,1/10W,+1%,	2
R44-R53	X194606190	CHIP RESISTOR	619 OHM 1/10W 1%	2
R45-R54	2009722	CHIP RESISTOR	TP,294OHM,1/10W,+1%,	2
R46-R55	2008780	CHIP RESISTOR	475 OHM 1/10W 1%	2
R47-R56	2008959	CHIP RESISTOR	1.87K OHM 1/10W 1%	2
R57-R62	2001524	THICK FILM CHIP RESISTOR	470 OHM 1/10W 5%	2
R58	2011796	CHIP RESISTOR	TP,4.02KOHM,1/10W,+1%,	1
R59	2024301	CHIP RESISTOR	TP,174OHM,1/10W,+1%,	1
R60	2002018	CHIP RESISTOR	TP,1.4KOHM,1/10W,+1%,	1
R61-R63	2013099	CHIP RESISTOR	TP,4.7KOHM,1/2W,+5%,	2
R65-R66	2005302	CHIP RESISTOR	3.9K OHM	2
R67-R68	2001524	THICK FILM CHIP RESISTOR	470 OHM 1/10W 5%	2
R69-R70	X193011032	CHIP RESISTOR ERJ-6GEYJ103V	10K OHM 1/10W 5%	2
R72-R95	2005071	CHIP RESISTOR	12K OHM 1/10W 5%	24
R8-R9-R16	X193011032	CHIP RESISTOR ERJ-6GEYJ103V	10K OHM 1/10W 5%	3
R96	X193011032	CHIP RESISTOR ERJ-6GEYJ103V	10K OHM 1/10W 5%	1
R97	2011800	CHIP RESISTOR	TP,16KOHM,1/4W,+5%,	1
R98-R101	2008818	CHIP RESISTOR	TP,1.8KOHM,1/10W,+5%,	4
ZD1	2013578	ZENER DIODE		1
300	2024295	BOARD ASSY., P/S 240V	NB 2024294 IS 120v	1
301	1017043	FRAME, POWER SUPPLY		1
302	B300204211	C.B.S. SCREW	M3X6	5
B101-B201	2011841	BEADS CORE		2
B151	2003171	BEADS CORE		1
CN1	2000295	CONNECTOR	2 PIN	1
CN2	X601111000	CONNECTOR	10PIN	1

EPSON DLQ3000PLUS

Page 5

REF	PART NO	DESCRIPTION	REMARKS	QTY
CN3	X601110600	CONNECTOR	6 PIN	1
C1	2011827	FILM CAPACITOR	BL,0.68UF,250V,+20%,	1
C111-C211	2011837	CAPACITOR	BL,150UF,400V,+20%,	2
C112-C212	2011830	CAPACITOR	TP,100UF,25V,+20%,	2
C113-C155	X236104010	FILM CAPACITOR	0.1UF 50V 5%	2
C114-C214	2001087	PLASTIC FILM CAPACITOR	2200PF 50V 5%	2
C115-C116	2011828	FILM CAPACITOR	BL,3300PF,1.2KV,+5%,	2
C117	2011829	CAPACITOR	BL,2200UF,16V,+20%,	1
C118	X224221031	CERAMIC CAPACITOR	0.01UF DC50V +80-20%	1
C151-C152	2011831	CAPACITOR	BL,3300UF,50V,+20%,	2
C154	X200151021	CAPACITOR	1000UF 10V 20%	1
C156	2011833	CAPACITOR	TP,33UF,16V,+20%	1
C157	2003109	CAPACITOR	470UF 6.3V 20%	1
C158	2003142	FILM CAPACITOR	0.01UF 50V 5%	1
C159	X220225610	CERAMIC CAPACITOR	560PF DC50V 20%	1
C2	2001138	FILM CAPACITOR	0.22UF 25V 20%	1
C213	X236104010	FILM CAPACITOR	0.1UF 50V 5%	1
C215-C216	2011828	FILM CAPACITOR	BL,3300PF,1.2KV,+5%,	2
C251-C252	2011831	CAPACITOR	BL,3300UF,50V,+20%,	2
C3-C4	2005087	CERAMIC CAPACITOR	BL,4700PF,0V,+20%,	2
C8-C31	2005087	CERAMIC CAPACITOR	BL,4700PF,0V,+20%,	2
C9	2005087	CERAMIC CAPACITOR	BL,4700PF,0V,+20%,	1
DB101	X340350060	DIODE BRIDGE	600V 5A	1
D101-D103	X320011449	DIODE	40V 0.6A 0.2W	2
D102-D153	X320011201	DIODE	SI 60V 150MA	2
D104-D204	X320011220	DIODE	500V 0.8A	2
D131-D152	X320011449	DIODE	40V 0.6A 0.2W	2
D151-D251	B300204311	C.B.S. SCREW	M3X8	2
D151-D251	1013213	HEAT SINK		2
D151-D251	2011459	DIODE	100V 11A	2
D154-D181	X320011201	DIODE	SI 60V 150MA	2
D155	X320010990	DIODE	40V 2.6A	1
D201-D203	X320011449	DIODE	40V 0.6A 0.2W	2
D202	X320011201	DIODE	SI 60V 150MA	1
D231-D252	X320011449	DIODE	40V 0.6A 0.2W	2
D254-D281	X320011201	DIODE	SI 60V 150MA	2
F1	X502100100	FUSE HOLDER		2
F1	X502200060	FUSE COVER		1
F1	2011839	FUSE	250V,5A,	1
IC101	X440074758	VOLTAGE REGULATOR	ADJ.PREC. SHUNT REG	1
IC151	X440034940	LINEAR IC	BIPOLAR SWREG DIP	1
IC201	X440074758	VOLTAGE REGULATOR	ADJ.PREC. SHUNT REG	1
L1	2011858	CHOKE COIL	27MH,1.5A,	1
L151	Y565201004	CHOKE COIL	200UH 2.5A	1
PC101	2007060	PHOTO COUPLER	60MA 150MW 55V 50MA	1
PC102	2007059	PHOTO COUPLER	5V 60MA	1
PC201	2007060	PHOTO COUPLER	60MA 150MW 55V 50MA	1
Q101-Q201	X510180360	INSULATION SPACER		2
Q101-Q201	X520000160	HEAT SINK		2
Q101-Q201	1002674	C.B.S-TITE SCREW	M3X12	2
Q101-Q201	2011458	FET	900V,7A,150W,	2
Q102-Q202	2000623	TRANSISTOR	50V 2A 900MW	2
Q103-Q153	X300101589	TRANSISTOR	PNP 50V 150MA 400MW	2
Q151	X300146900	TRANSISTOR	60V 5A 200W	1
Q151	1019221	HEAT SINK		1

EPSON

DLQ3000PLUS

Page 6

REF	PART NO	DESCRIPTION	REMARKS	QTY
Q152	X300168009	TRANSISTOR, 2SA1680-TPE6	PNP 50V 2A 900MW	1
Q154	X302181589	TRANSISTOR	NPN 50V 150MA 400MW	1
Q155	X312211439	TRANSISTOR	50V 100MA 300MW 10K	1
Q203-Q253	X300101589	TRANSISTOR	PNP 50V 150MA 400MW	2
R1	2011836	CARBON FILM RESISTOR	TP,390KOHM,1/2W,+5%,	1
R111-R211	2011472	METAL OXIDE FILM RESISTOR	BL,300OHM,1W,+5%,	2
R112-R212	2011823	METAL OXIDE FILM RESISTOR	BL,0.68OHM,3W,+2%,	2
R113-R121	X155414722	CARBON FILM RESISTOR	4.7K OHM	2
R114-R116	X155412712	CARBON FILM RESISTOR	270 OHM 1/4W 5%	3
R117-R132	X155410102	CARBON FILM RESISTOR	1 OHM 1/4W 5%	2
R118-R126	2013478	METAL OXIDE FILM RESISTOR	BL,100KOHM,1W,+5%,	2
R119-R160	X155411032	CARBON FILM RESISTOR	10K OHM 1/4W 5%	2
R120-R220	X155412422	CARBON FILM RESISTOR	2.4K OHM 1/4W 5%	2
R123	2002320	CARBON FILM RESISTOR	TP,39OHM,1/4W,+5%,	2
R124	X130222216	METAL OXIDE FILM RESISTOR	220 OHM 2W 5%	2
R125	X155411032	CARBON FILM RESISTOR	10K OHM 1/4W 5%	1
R127.R128	2013478	METAL OXIDE FILM RESISTOR	BL,100KOHM,1W,+5%,	2
R131-R153	2003104	METAL FILM RESISTOR	0.22 OHM 2W 5%	2
R151-R152	2003105	METAL OXIDE FILM RESISTOR	470 OHM 2W 5%	2
R154-R182	X155412022	CARBON FILM RESISTOR	2K OHM 1/4W 5%	2
R155	X155412032	CARBON FILM RESISTOR	20K OHM 1/4W 5%	1
R156-R162	X155413012	CARBON FILM RESISTOR	300 OHM 1/4W 5%	2
R157-R169	X155415112	CARBON FILM RESISTOR	510 OHM 1/4W 5%	2
R158	X155411042	CARBON FILM RESISTOR	100K OHM 1/4W 5%	1
R159	X148194751	HIGH STAB. M/ FILM RESISTOR	4.75K OHM 1/4W 1%	1
R161	X155412002	CARBON FILM RESISTOR	20 OHM 1/4W 5%	1
R163	X155413622	CARBON FILM RESISTOR	3.6K OHM 1/4W 5%	1
R164	X155411012	CARBON FILM RESISTOR	100 OHM 1/4W 5%	1
R165	X155411022	CARBON FILM RESISTOR	1K OHM 1/4W 5%	1
R166	X155412042	CARBON FILM RESISTOR	200K OHM 1/4W 5%	1
R167	X155413022	CARBON FILM RESISTOR	3K OHM 1/4W 5%	1
R168-R170	X155411032	CARBON FILM RESISTOR	10K OHM 1/4W 5%	2
R171-R271	X155411522	CARBON FILM RESISTOR	1.5K OHM 1/4W 5%	2
R172-R272	X155415622	CARBON FILM RESISTOR	5.6K OHM 1/4W 5%	2
R173-R273	X155411222	CARBON FILM RESISTOR	1.2K OHM 1/4W 5%	2
R174-R219	X155411032	CARBON FILM RESISTOR	10K OHM 1/4W 5%	2
R175	X155412722	CARBON FILM RESISTOR	2.7K OHM 1/4W 5%	1
R181	2011818	HIGH STAB. M/ FILM RESISTOR	TP,84.5KOHM,1/4W,+1%,	1
R2	2011822	CEMENT RESISTOR	BL,4.7OHM,5W,+10%,	1
R213-R221	X155414722	CARBON FILM RESISTOR	4.7K OHM	2
R214-R216	X155412712	CARBON FILM RESISTOR	270 OHM 1/4W 5%	3
R217-R232	X155410102	CARBON FILM RESISTOR	1 OHM 1/4W 5%	2
R218	2013478	METAL OXIDE FILM RESISTOR	BL,100KOHM,1W,+5%,	1
R228	2013478	METAL OXIDE FILM RESISTOR	BL,100KOHM,1W,+5%,	1
R231	2003104	METAL FILM RESISTOR	0.22 OHM 2W 5%	1
R256	X155413012	CARBON FILM RESISTOR	300 OHM 1/4W 5%	1
R257	X155415112	CARBON FILM RESISTOR	510 OHM 1/4W 5%	1
R270	X155411032	CARBON FILM RESISTOR	10K OHM 1/4W 5%	1
R3-R4	2011477	CEMENT RESISTOR	BL,4.7OHM,5W,+5%,	2
TY101	B300204311	C.B.S. SCREW	M3X8	1
TY101	1017063	HEAT SINK		1
TY101	2011456	TRIAC	600V,8A,0.5W,	1
T101-T201	2011834	TRANSFORMER		2
ZD151	2011463	ZENER DIODE	150MA 400MW 6.9V 7.2V	1
ZD152	X330030369	ZENER DIODE		1
ZD153	2011464	ZENER DIODE	150MA 400W 6.9V 7.2V	1

EPSON DLQ3000PLUS

Page 7

REF	PART NO	DESCRIPTION	REMARKS	QTY
ZD154	2011463	ZENER DIODE	150MA 400MW 6.9V 7.2V	1
ZD155	2004320	ZENER DIODE	150MA 400MW 5.2W 5.5V	1
ZD181	2011463	ZENER DIODE	150MA 400MW 6.9V 7.2V	1
ZD182	2011463	ZENER DIODE	150MA 400MW 6.9V 7.2V	1
ZD183	2011463	ZENER DIODE	150MA 400MW 6.9V 7.2V	1
ZD184	2011463	ZENER DIODE	150MA 400MW 6.9V 7.2V	1
ZD185	2011463	ZENER DIODE	150MA 400MW 6.9V 7.2V	1
330	2011768	WIRE-HARNESS		1
331	2023822	HARNESS		1
332	2023825	HARNESS		1
333	2011772	WIRE-HARNESS		1
334	2023826	HARNESS		1
335	2023827	HARNESS		1
336	2024271	HARNESS		1
337	2014520	WIRE HARNESS		2
400	2006741	POWER CABLE (BS31303SA-SR-10A)	2.0V	1
400	2020110	POWER CABLE		1
412	2023821	HARNESS		1
450	2022979	CONTROL PANEL		1
451	2023828	FAN ASSEMBLY		1
500	2025853	PRINTER MECH.(ASP), M-5P60-100		1
501	F358205000	BELT DRIVEN PULLEY ASSEMBLY		1
502	1033804	FRAME, CR		1
503	1033824	SHAFT, CR, GUIDE, UPPER		1
504	1033823	SHAFT, CR, GUIDE, LOWER		1
505	1033821	BUSHING, PARALLEL, ADJUST		1
506	1033817	SPACER, PE, FRONT		1
507	1033816	LEVER, PE, FRONT		1
508	1033810	HOLDER, HEAD, CABLE		1
509	1033820	BUSHING, M		1
510	1033819	BUSHING, 14MM		1
511	1001728	OIL PAD, PLAIN, UPPER		1
512	1001729	OIL PAD, PLAIN, LOWER		1
513	1016779	COVER OIL PAD		1
514	1001736	GROUNDING PLATE, CR, MOTOR		1
515	1016628	TIMING BELT, CR		1
516	1033807	LEVER, PULLEY, DRIVEN		1
517	1033803	PAPER GUIDE		1
518	1001754	TIMING BELT, PF, FRONT		1
519	1001753	TIMING BELT, PF, REAR		1
520	1033829	ROLLER, PAPER LOAD, DRIVE		1
521	1001756	PULLEY, LOAD, ROLLER		1
522	1033812	COMBINATION GEAR, 16, 20		1
523	1001761	SPUR GEAR, 16		1
524	1001762	BUSHING, LOAD, ROLLER		1
525	1001766	SPUR GEAR, 18		1
526	1001767	COMBINATION GEAR, 15, 18		1
527	1001769	COMBINATION GEAR, 16, 34, 93		1
528	1001775	SPUR GEAR, 16		1
529	1001785	LEVER, RELEASE		1
530	1001787	LEVER, RELEASE, SUPPORT		1
531	1001788	LINK, RELEASE, LEVER		1
532	1001789	SPUR GEAR, 25		1
533	1001791	SPUR GEAR, 15.5		1
534	1001795	SHAFT, PF, TENSION		1

EPSON

DLQ3000PLUS

Page 8

REF	PART NO	DESCRIPTION	REMARKS	QTY
535	1033806	LEVER, CR, GUIDE, LOWER		1
536	1036848	SHEET, PROTECTION, FFC		1
537	1033796	FRAME ASSY., LEFT		1
538	1033794	FRAME ASSY., RIGHT		1
539	1033772	FRAME, BASE		1
540	1001763	HOLDER, LOAD, ROLLER		1
541	1001780	LEVER, PAPER GUIDE, CHANGE		2
542	1001781	EXTENSION SPRING, 350		2
543	1001782	LEVER, PAPER GUIDE, CHANGE, SUPPORT		2
544	1001783	EXTENSION SPRING, 180		2
545	1001784	SHAFT, PAPER GUIDE, CHANGE		
546	1033774	ROLLER ASSY., PF, SUPPORT		
547	F344210020	CARTRIDGE MOUNTING LEVER		
548	1033766	PIN, LOCATE, CARTRIDGE		
549	1016630	SPUR GEAR, 18		
550	1016652	SPUR GEAR, 12		1
551	F355211000	COLOUR SELECT DRIVE LEVER		1
552	F355212010	COLOUR SELECT DRIVE GEAR		1
553	2025472	DETECTOR ASSY., RC		1
554	1033922	HOLDER, RIBBON CARTRIDGE		1
555	1001740	COMPRESSION SPRING, 645		1
556	1001747	FASTENER, RIBBON, PLANET		1
557	1001748	SPUR GEAR, 10.4		2
558	1001749	SPUR GEAR, 21.6		1
559	1016631	CAM, CS		1
560	1033769	CARRIAGE SUB ASSY.		1
561	1001846	LEVER ASSY., PLANET		1
562	1001848	GEAR ASSY., RIBBON, DRIVE		1
563	1001879	SPACER, CS		1
564	2000970	MOTOR ASSY., CS	16W	1
565	2024333	BOARD ASSEMBLY, CS		1
566	1020600	HOLDER ASSY., RIBBON MASK;B		1
567	1033822	SLEEVE, HOLDER, RIBBON CARTRIDGE		1
568	1033815	HOLDER, PJ, PE, DETECT		1
569	1033811	SPUR GEAR, 40		1
570	1033780	LEVER ASSY., PAPER EJECT		1
571	2024189	DETECTOR, PE, REAR		1
572	1016613	LEVER, CR		1
573	1016614	EXTENSION SPRING, 154		1
574	1033767	PRESSING PLATE, FILM RIBBON		1
575	1033802	DETECTOR ASSY, PT		1
576	2014328	CONNECTOR SWITCH;B		1
577	1033786	ROLLER ASSY., PAPER EJECT, DRIVE		1
578	1001772	SPUR GEAR, 16		1
579	1033790	PLATEN		1
580	1025296	PAPER SUPPORT		1
581	1033793	SHAFT, TR, DRIVE		1
582	1032525	TRACTOR, LEFT		1
583	1032526	TRACTOR, RIGHT		1
584	1033814	SPUR GEAR, 25		1
585	1001794	SHAFT, TRACTOR, REAR		1
586	2024188	HARNESS, PG		1
587	2024185	HARNESS, RE		1
588	2025191	HARNESS, MACHINE, GROUNDING		1
589	1002581	GROUNDING PLATE, FRAME, BASE		1
590	1033809	FRAME, PT		1

EPSON DLQ3000PLUS

Page 9

REF	PART NO	DESCRIPTION	REMARKS	QTY
591	2011515	CABLE, HEAD, FRONT		1
592	2011516	CABLE, HEAD, REAR		1
593	F355201020	CARRIAGE MOTOR DAMPER		4
594	2024180	DETECTOR ASSY., PJ		1
595	2024182	DETECTOR ASSEMBLY, PGHP		1
596	2011727	MOTOR ASSY., CR		1
597	2024263	MOTOR ASSEMBLY, PF		1
598	2024227	FAN MOTOR		1
599	1033805	MOUNTING PLATE, FAN MOTOR		1
600	2024184	HARNESS, HP		1
601	2016332	DETECTOR, HP, B	0V,0A,0W,	2
602	F334005100	DAMPER		4
603	F334005110	DAMPER SPACER		4
604	F334005230	PLATEN SHAFT HOLDER		5
605	F334005280	TRACTOR REDUCTION GEAR SPRING		1
606	F334005370	PLATEN SHAFT HOLDER		1
607	1033827	EXTENSION SPRING, 27.6		1
608	B150300314	RETAINING RING	TYPE-E(1.5)	1
609	B150300811	RETAINING RING	TYPE-E(5)	4
610	B150300711	RETAINING RING	TYPE-E(4)	1
611	B150300611	RETAINING RING	TYPE-E(3)	1
612	B100166012	PLAIN WASHER	8X0.5X15	2
613	B100166211	PLAIN WASHER	5X0.5X10	2
614	B101253390	LEAF SPRING	8.2X0.15X15	1
615	1036388	LEAF SPRING		1
616	B300204411	C.B.S. SCREW	M3X10	2
617	B040300611	CUP SCREW	M2X8	3
618	B300204211	C.B.S. SCREW	M3X6	25
619	1001855	C.B.B. SCREW	M5X10	2
620	B080450111	HEXAGON NUT	M4	4
621	B045000111	C.P.(P) SCREW	M3X6	2
622	B040303211	CUP SCREW	M3X16	4
623	2024264	MOTOR ASSEMBLY, PG		1
624	1036447	SOUND ABSORBER, 318*20*8		1
625	1020564	PAD, CLEANING		2
626	B040550611	C.P.S.P.SCREW	M3X14	1
627	1002916	SHIELD PROTECT		1
628	1016275	OLE PAD, CLEANING		1
629	B300204311	C.B.S. SCREW	M3X8	1
630	1023599	EXTENSION SPRING, 1.97		1
631	1023600	EXTENSION SPRING, 4.95		1
632	1033827	SHAFT, PE, FRONT		1
633	1023825	SPRING, CR, GUIDE, LOWER		1
634	2024187	HARNESS, PE, FRONT		1
635	2024186	HARNESS, RE, REAR		1
636	B040550411	C.P.S.P.SCREW	M3X6 F/ZN	2
637	1033773	LEVER, PAPER GUIDE, CHANGE		1
638	1024130	C.B.P-TITE SCREW, 3X6, F/ZN		1
639	B302502311	C.P.S.P.SCREW		1
640	1033818	COMBINATION GEAR, 8, 26		1
650	F038020	PRINT HEAD, DH24-05B	INC. RIBBON MASK	1
1	5006866	IND. CARTON BOX - EUROPE		1
2	5006870	OUTER CARTON BOX		1
3	5006354	PAD SET, PRINTER		1
4	5006347	PAD, ACCESSORY		1

EPSON DLQ3000PLUS

Page 13

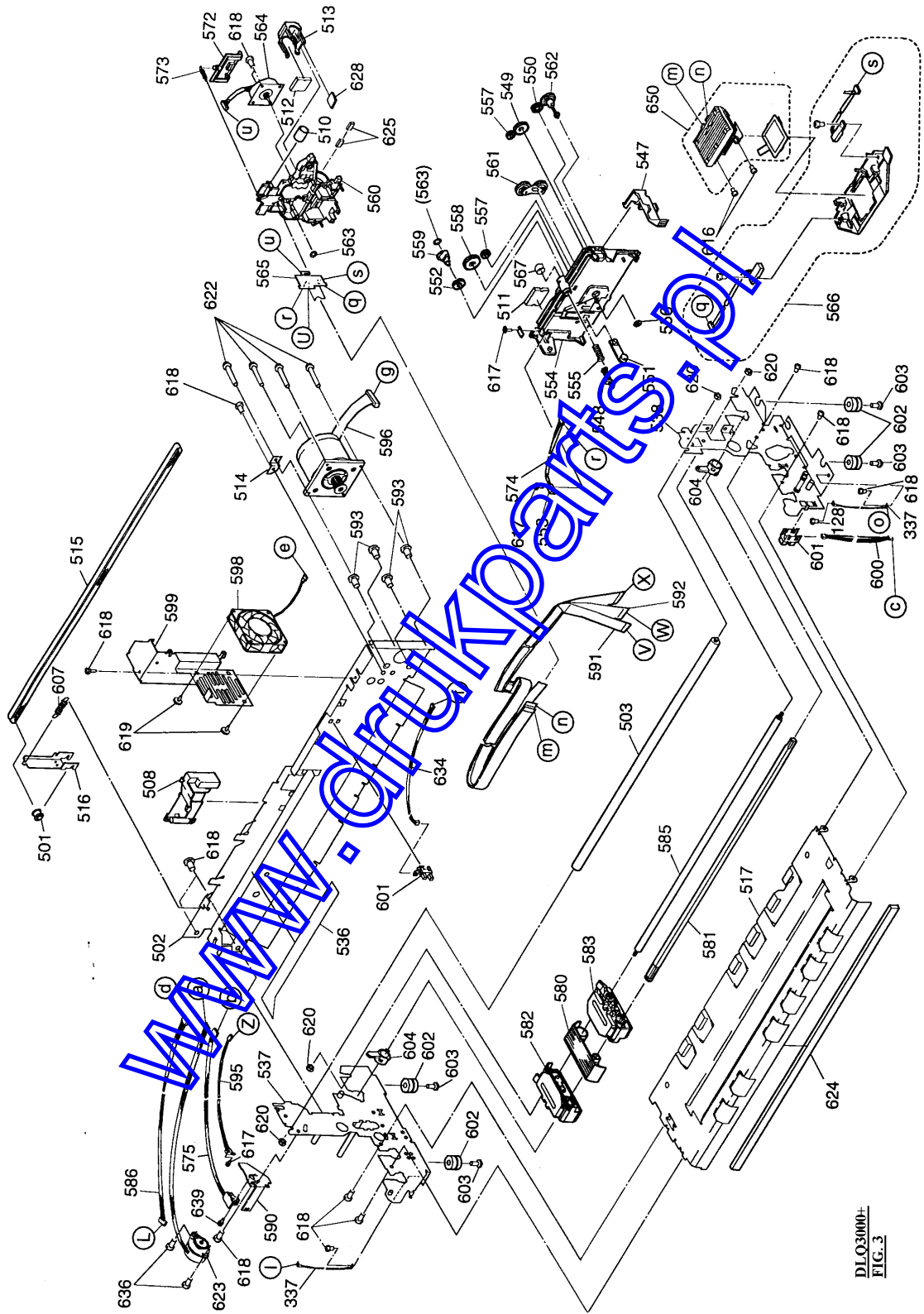

DLQ3000+
FIG. 3

EPSON DLQ3000PLUS

Page 14

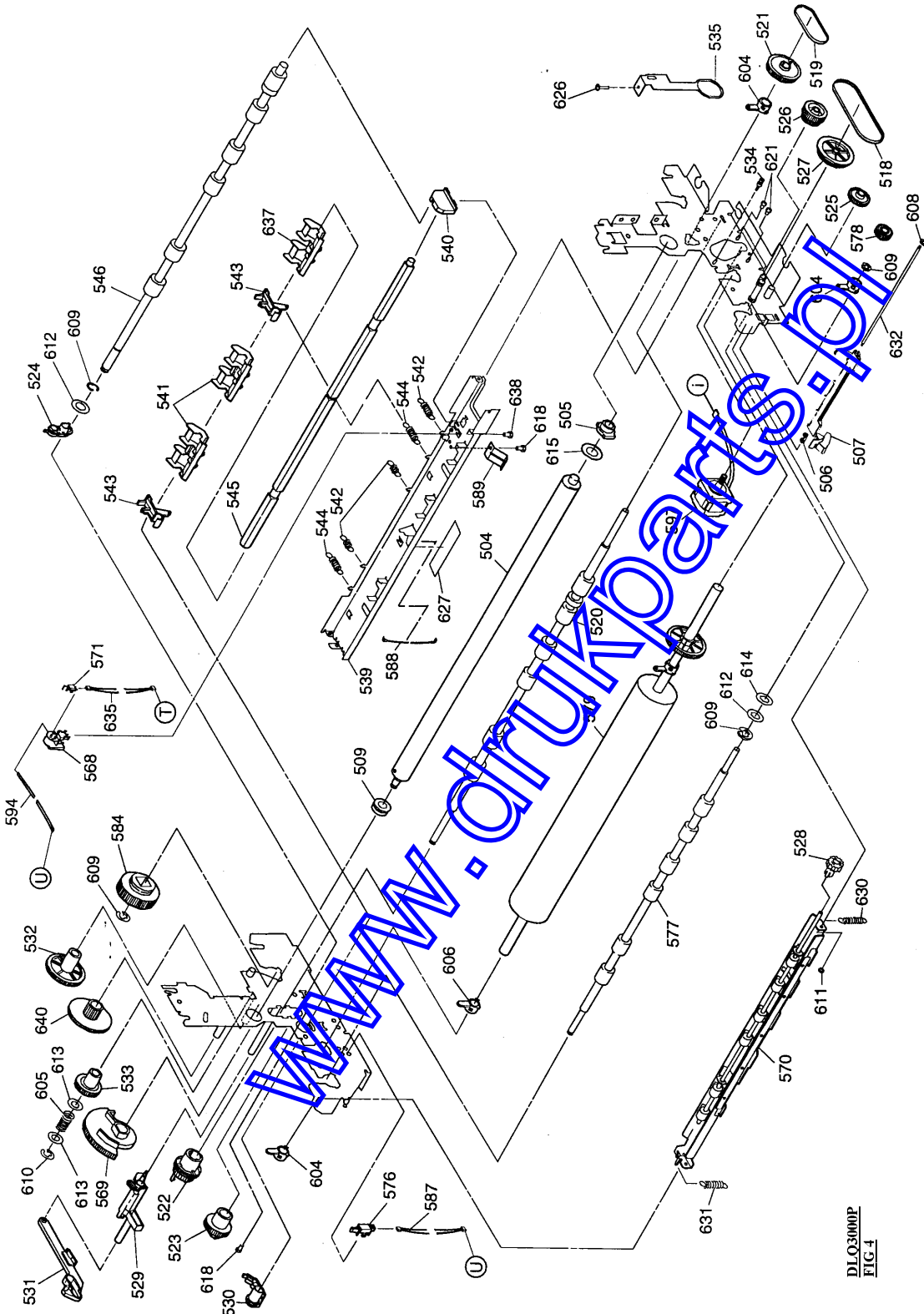

DLQ3000P
FIG. 4

EPSON DLQ3000PLUS

Page 15

